

***ADDENDUM***  
***TO***  
***FUNCTIONAL SERVICING REPORT***

**HILLSBURGH HEIGHTS INC.**  
**PROPOSED RESIDENTIAL SUBDIVISION**

**5916 TRAFALGAR ROAD NORTH**

**HILLSBURGH URBAN AREA**

**TOWN OF ERIN**

**COUNTY OF WELLINGTON**

**FILE NOS. 23T-21002, Z21-09**

**MAY 26<sup>TH</sup> 2023**

**ADDENDUM  
TO  
FUNCTIONAL SERVICING REPORT**

**HILLSBURGH HEIGHTS INC.  
PROPOSED RESIDENTIAL SUBDIVISION**

**5916 TRAFALGAR ROAD NORTH**

**HILLSBURGH URBAN AREA**

**TOWN OF ERIN**

**COUNTY OF WELLINGTON**

**FILE NOS. 23T-21002, Z21-09**

**MAY 26<sup>TH</sup> 2023**



## CONTENTS

	Page
<b>1. RESPONSES TO THIRD SUBMISSION COMMENTS RELATING TO STORMWATER MANAGEMENT</b>	<b>1</b>

## DRAWINGS

**DRAWING PL-1 Rev. 8 - Draft Plan**

**DRAWING PDR-1 Rev. 3 - Pre-Development Drainage Plan**

**DRAWING PDR-2 - Post Development Drainage Plan**

**DRAWING SWM-1 Rev. 3 - Stormwater Management Pond - Pond 1 Plan and Sections**

**DRAWING SWM-2 Rev. 3 - Stormwater Management Pond - Pond 2 Plan and Sections**

## APPENDICES

**APPENDIX I: Diversion Ditch Calculations**

**APPENDIX II: Sediment Storage Area Calculations**

# **1. RESPONSES TO THIRD SUBMISSION COMMENTS RELATING TO STORMWATER MANAGEMENT**

This Addendum addresses the following comments received pursuant to the 3<sup>rd</sup> Submission for the subject application.

## **A. Town of Erin**

### **11. External Drainage Ditch - Block 15 Draft Plan Revision 8**

The 100 year flow from the upstream Drainage Area of 6.84 ha (Agricultural Land) is 1.4 m<sup>3</sup>/s. The capacity of the Diversion Ditch is 12.6 m<sup>3</sup>/s at a depth of 0.5m. Refer to attached Appendix I for calculations.

### **13. Sediment Drying Areas in SWM Ponds**

Notwithstanding that sediment drying areas are not used by Contractors for removing sediment from SWM ponds, as required by the Town sediment drying areas are shown on SWM Pond Drawing SWM-1 Rev. 3 and SWM-2 Rev. 3.

When other Municipalities required sediment drying areas the design reflected the following operational features to minimize the damage to vegetation and minimize the disturbed area:

- (i) Provide temporary 1.2m high interlocking plastic barriers [New Jersey type barriers], filled with water, around the perimeter of the sediment drying areas with a geotextile membrane on the inside face of the barriers to allow water to drain and contain the sediment.
- (ii) Limit the height of sediment to 1.0m.

The sediment drying areas are, accordingly, based on these design parameters.

**1. RESPONSES TO THIRD SUBMISSION COMMENTS RELATING TO STORMWATER MANAGEMENT (CONT'D)**

**A. Town of Erin (Cont'd)**

**13. Sediment Drying Areas in SWM Ponds (Cont'd)**

Refer to the attached Appendix II for the sediment drying areas storage volume calculations. A storage area of 530m<sup>2</sup> is provided in SWM Pond No. 1 (east) and an area of 467m<sup>2</sup> is required. A storage area of 731m<sup>2</sup> is provided in SWM Pond No. 2 (west) and an area of 458m<sup>2</sup> is required.

**B. Credit Valley Conservation**

**Pre and Post Drainage Areas to SWM Pond No. 2**

The Pre-Development Drainage Area Plan as shown on Drawing PDR-1 shows that the Pre-Development Drainage Area to the downstream Wetland is 24.97 ha (including SWM pond area).

The Post Drainage Area to SWM Pond No. 2 is shown on Drawing PDP-1 and comprises an area of 20.19 ha.

The SWM is sized to meet the pre-development conditions.

## **APPENDIX I**

### **Diversion Ditch Calculations**

### Hillsburg diversion channel

Total drainage area (ha)		6.84
Coeffeicient		0.35 ( cultivated land)
storm	intensity	Flow
2	93.6	0.6
5	123.4	0.8
10	143.5	1.0
25	168.2	1.1
50	186.7	1.2
100	204.5	1.4

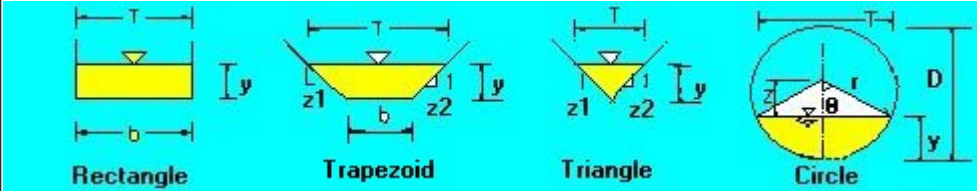
<h2 style="margin: 0;">The open channel flow calculator</h2> <p style="margin: 0;">TRAPAZOID</p>		
<p style="color: red; margin: 0;">Select Channel Type:</p> <div style="border: 1px solid gray; padding: 2px; display: inline-block;">Trapezoid ▾</div>		
<div style="border: 1px solid gray; padding: 2px; display: inline-block;">Depth from Q ▾</div>	<p style="color: red; margin: 0;">Select unit system:</p> <div style="border: 1px solid gray; padding: 2px; display: inline-block;">Meter(m) ▾</div>	
<p>Channel slope: <input style="width: 80px;" type="text" value="1.1"/></p> <div style="border: 1px solid gray; padding: 2px; display: inline-block; width: 60px;">m/m</div>	<p>Water depth(y): <input style="width: 80px;" type="text" value="0.19"/></p> <div style="border: 1px solid gray; padding: 2px; display: inline-block; width: 40px;">m</div>	<p>Bottom width(b) <input style="width: 80px;" type="text" value=".5"/></p> <div style="border: 1px solid gray; padding: 2px; display: inline-block; width: 40px;">m</div>
<p>Flow velocity <input style="width: 80px;" type="text" value="7.102585"/></p> <div style="border: 1px solid gray; padding: 2px; display: inline-block; width: 60px;">m/s</div>	<p>LeftSlope (Z1): <input style="width: 40px;" type="text" value="3"/></p> <div style="border: 1px solid gray; padding: 2px; display: inline-block; width: 60px;">z1/y</div>	<p>RightSlope (Z2): <input style="width: 40px;" type="text" value="3"/></p> <div style="border: 1px solid gray; padding: 2px; display: inline-block; width: 60px;">z2/y</div>
<p>Flow discharge <input style="width: 80px;" type="text" value="1.4"/></p> <div style="border: 1px solid gray; padding: 2px; display: inline-block; width: 60px;">m<sup>3</sup>/s</div>	<p>Input n value <input style="width: 80px;" type="text" value="0.035"/> or select n</p>	
<div style="border: 1px solid gray; padding: 2px; display: inline-block;">Calculate!</div>	<p>Status: <span style="color: red;">Calculation finished</span></p>	<div style="border: 1px solid gray; padding: 2px; display: inline-block;">Reset</div>
<p>Wetted perimeter <input style="width: 80px;" type="text" value="1.68"/></p> <div style="border: 1px solid gray; padding: 2px; display: inline-block; width: 40px;">m</div>	<p>Flow area <input style="width: 80px;" type="text" value="0.2"/></p> <div style="border: 1px solid gray; padding: 2px; display: inline-block; width: 60px;">m<sup>2</sup></div>	<p>Top width(T) <input style="width: 80px;" type="text" value="1.62"/></p> <div style="border: 1px solid gray; padding: 2px; display: inline-block; width: 40px;">m</div>
<p>Specific energy <input style="width: 80px;" type="text" value="2.76"/></p> <div style="border: 1px solid gray; padding: 2px; display: inline-block; width: 40px;">m</div>	<p>Froude number <input style="width: 80px;" type="text" value="6.5"/></p>	<p>Flow status</p> <div style="border: 1px solid gray; padding: 2px; display: inline-block;">Supercritical flow</div>
<p>Critical depth <input style="width: 80px;" type="text" value="0.47"/></p> <div style="border: 1px solid gray; padding: 2px; display: inline-block; width: 40px;">m</div>	<p>Critical slope <input style="width: 80px;" type="text" value="0.0189"/></p> <div style="border: 1px solid gray; padding: 2px; display: inline-block; width: 60px;">m/m</div>	<p>Velocity head <input style="width: 80px;" type="text" value="2.57"/></p> <div style="border: 1px solid gray; padding: 2px; display: inline-block; width: 40px;">m</div>

Copyright 2000 Dr. Xing Fang, Department of Civil Engineering, Lamar University.

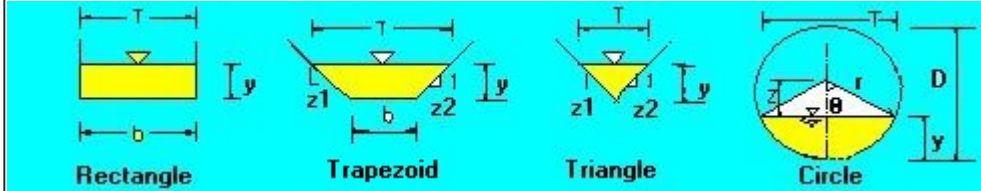

<h2 style="margin: 0;">The open channel flow calculator</h2> <p style="margin: 0; font-weight: normal;">TRIANGLE</p>		
<p style="color: red; margin: 0;">Select Channel Type:</p> <div style="border: 1px solid gray; padding: 2px; display: inline-block;">Trapezoid ▾</div>		
<div style="border: 1px solid gray; padding: 2px; display: inline-block;">Depth from Q ▾</div>	<p style="color: red; margin: 0;">Select unit system:</p> <div style="border: 1px solid gray; padding: 2px; display: inline-block;">Meter(m) ▾</div>	
<p>Channel slope: <input style="width: 80px;" type="text" value="1.1"/></p> <div style="border: 1px solid gray; padding: 2px; display: inline-block; width: 60px;">m/m</div>	<p>Water depth(y): <input style="width: 80px;" type="text" value="0.25"/></p> <div style="border: 1px solid gray; padding: 2px; display: inline-block; width: 40px;">m</div>	<p>Bottom width(b) <input style="width: 80px;" type="text" value="0"/></p> <div style="border: 1px solid gray; padding: 2px; display: inline-block; width: 40px;">m</div>
<p>Flow velocity <input style="width: 80px;" type="text" value="7.187998"/></p> <div style="border: 1px solid gray; padding: 2px; display: inline-block; width: 60px;">m/s</div>	<p>LeftSlope (Z1): <input style="width: 40px;" type="text" value="3"/></p> <div style="border: 1px solid gray; padding: 2px; display: inline-block; width: 60px;">z1/y</div>	<p>RightSlope (Z2): <input style="width: 40px;" type="text" value="3"/></p> <div style="border: 1px solid gray; padding: 2px; display: inline-block; width: 60px;">z2/y</div>
<p>Flow discharge <input style="width: 80px;" type="text" value="1.4"/></p> <div style="border: 1px solid gray; padding: 2px; display: inline-block; width: 60px;">m<sup>3</sup>/s</div>	<p>Input n value <input style="width: 80px;" type="text" value="0.035"/> or select n</p>	
<div style="border: 1px solid gray; padding: 2px; display: inline-block;">Calculate!</div>	<p>Status: <span style="color: red;">Calculation finished</span></p>	<div style="border: 1px solid gray; padding: 2px; display: inline-block;">Reset</div>
<p>Wetted perimeter <input style="width: 80px;" type="text" value="1.61"/></p> <div style="border: 1px solid gray; padding: 2px; display: inline-block; width: 40px;">m</div>	<p>Flow area <input style="width: 80px;" type="text" value="0.19"/></p> <div style="border: 1px solid gray; padding: 2px; display: inline-block; width: 60px;">m<sup>2</sup></div>	<p>Top width(T) <input style="width: 80px;" type="text" value="1.53"/></p> <div style="border: 1px solid gray; padding: 2px; display: inline-block; width: 40px;">m</div>
<p>Specific energy <input style="width: 80px;" type="text" value="2.89"/></p> <div style="border: 1px solid gray; padding: 2px; display: inline-block; width: 40px;">m</div>	<p>Froude number <input style="width: 80px;" type="text" value="6.43"/></p>	<p>Flow status</p> <div style="border: 1px solid gray; padding: 2px; display: inline-block;">Supercritical flow</div>
<p>Critical depth <input style="width: 80px;" type="text" value="0.54"/></p> <div style="border: 1px solid gray; padding: 2px; display: inline-block; width: 40px;">m</div>	<p>Critical slope <input style="width: 80px;" type="text" value="0.0195"/></p> <div style="border: 1px solid gray; padding: 2px; display: inline-block; width: 60px;">m/m</div>	<p>Velocity head <input style="width: 80px;" type="text" value="2.64"/></p> <div style="border: 1px solid gray; padding: 2px; display: inline-block; width: 40px;">m</div>

Copyright 2000 Dr. Xing Fang, Department of Civil Engineering, Lamar University.

## **APPENDIX II**

### **Sediment Storage Area Calculations**

## SEDIMENT STORAGE CALCULATIONS

### A. SWM Pond No. 1 (East)

Permanent Pool Volume required as per FSR =  $4,666\text{m}^3$

Forebay Volume @ 1/3 of total =  $1,555\text{m}^3$

Sediment Drying Area Storage required @ 30% of Forebay Volume =  $467\text{m}^3$

Storage Capacity as per Drawing SWM-1 =  $530\text{m}^3$  (1m height)

### B. SWM Pond No. 2 (West)

Permanent Pool Volume required as per FSR =  $4,575\text{m}^3$

Forebay Volume @ 1/3 of total =  $1,525\text{m}^3$

Sediment Drying Area Storage required @ 30% of Forebay Volume =  $458\text{m}^3$

Storage Capacity as per Drawing SWM-2 =  $731\text{m}^3$



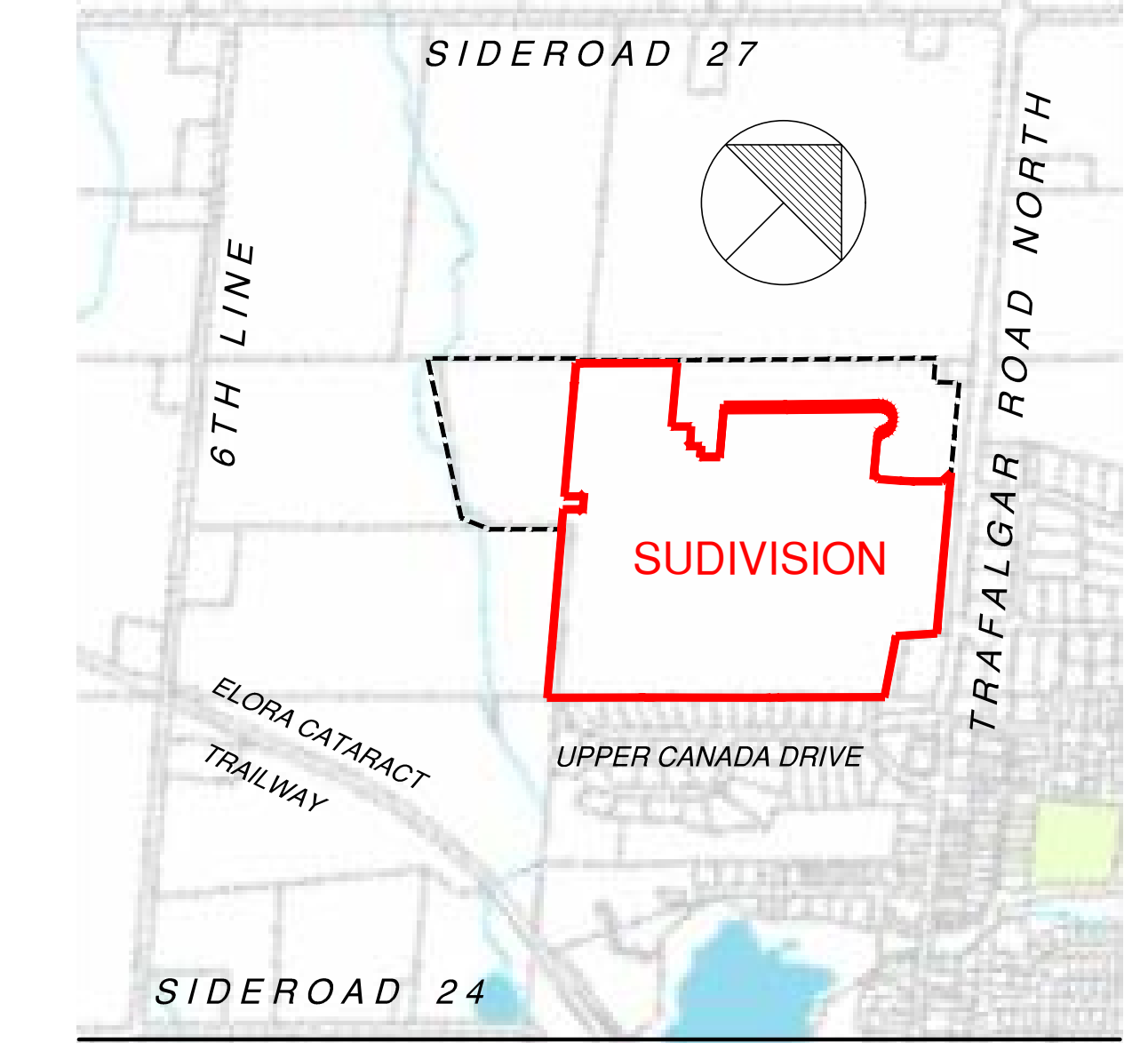

**KEY PLAN**  
1:12,000

**LOT SCHEDULE**

DESCRIPTION	TYPE	MINIMUM FRONTAGE	MINIMUM DEPTH	NUMBER OF LOTS	NUMBER OF UNITS
SINGLE DETACHED	X1	13.7m (45.0')	35.0m (114.8')	119	119
SINGLE DETACHED	X2	15.2m (50.0')	35.0m (114.8')	38	38
SINGLE DETACHED	X3	18.3m (60.0')	35.0m (114.8')	14	14
SINGLE DETACHED	X4	21.3m (70.0')	35.0m (114.8')	24	24
TOWNHOUSE	T	7.5m (24.6')	35.0m (114.8')	-	174
<b>TOTAL</b>				<b>195</b>	<b>369</b>

LAND USE	BLOCK / LOT	AREA
RESIDENTIAL	LOTS 1-195	11.63 ha. (28.74 Ac.)
PARK	BLOCK 1	1.75 ha. (4.32 Ac.)
SCHOOL	BLOCK 2	2.27 ha. (5.61 Ac.)
SWM POND	BLOCKS 3-4	4.09 ha. (10.11 Ac.)
	BLOCK 5	
ROADS	STREETS A-L	8.75 ha. (21.62 Ac.)
WALKWAY	BLOCK 6	0.04 ha. (0.10 Ac.)
HERITAGE HOUSE	BLOCK 7	0.29 ha. (0.72 Ac.)
TOWNHOUSING	BLOCKS 8-13A (174 UNITS)	5.13 ha. (12.68 Ac.)
0.30m RESERVE	BLOCKS 14-14E	0.01 ha. (0.02 Ac.)
5.0m DIVERSION DITCH	BLOCK 15	0.10 ha. (0.25 Ac.)
<b>TOTAL</b>		<b>34.06 ha. (84.17 Ac.)</b>

NO.	DESCRIPTION	DATE	BY
1	BLOCK 15 ADDED; FUTURE DEVELOPMENT LAYOUT DELETED; WIDTHS OF LOTS 7, 8, 9, 10, 11 AND 12 REVISSED	09.05.2023	D.K.H.
2	LOTS 25 TO 34 RELOCATED TO NORTH OF STREETS 'B' AND 'C'	03.02.2023	D.K.H.
3	STREET 'A' REALIGNED AT TRAFALGAR ROAD NORTH; STREET 'L' ADDED; LOTS REVISSED AND LAND USE AREAS REVISED	04.11.2022	D.K.H.
4	FUTURE DEVELOPMENT AREA DELETED FROM LIMIT OF SUBDIVISION	23.08.2022	D.K.H.
5	REVISIONS AS PER TOWN AND COUNTY COMMENTS	27.07.2022	D.K.H.
6	LIMIT OF PHASE 1 ADDED WITH FUTURE DEVELOPMENT BLOCKS 5-5A; TOWNHOUSING BLOCKS 11-14A ADDED AND LOT WIDTHS REVISSED; ST. 'A' R.O.W. INCREASED AND WALKWAY BLOCK 7 WIDTH INCREASED.	17.06.2022	D.K.H.
7	DIMENSIONS ADDED TO STREETS AND BLOCKS.	04.02.2022	D.K.H.
8	BEARINGS AND DISTANCES ADDED AS PER BSRAD LAND SURVEYORS PLAN REF. No. 21-14-619-00. DATED JAN., 7th 2022	07.01.2022	D.K.H.

**ADDITIONAL INFORMATION**  
 AS REQUIRED UNDER SECTION 51(17) OF THE PLANNING ACT (R.S.O. 1990 C.P. 13)  
 A) AS SHOWN ON DRAFT PLAN. G) AS SHOWN ON DRAFT AND KEY PLANS.  
 B) AS SHOWN ON DRAFT AND KEY PLAN. H) MUNICIPAL SERVICES TO BE PROVIDED.  
 C) AS SHOWN ON KEY PLANS. I) SOIL IS CLAYEY SILT.  
 D) AS SHOWN IN LAND USE SCHEDULE. J) AS SHOWN ON DRAFT PLAN.  
 E) AS SHOWN ON DRAFT PLAN. K) MUNICIPAL SERVICES TO BE PROVIDED.  
 F) AS SHOWN ON DRAFT PLAN. L) NONE.

**OWNER'S AUTHORIZATION:**  
 THE UNDERSIGNED, BEING THE OWNER OF THE SUBJECT LANDS HEREBY AUTHORIZE CANDEVCON LIMITED TO ACT ON OUR BEHALF AS AGENTS AND TO PREPARE AND SUBMIT A DRAFT PLAN OF SUBDIVISION FOR APPROVAL.  
 DATE: 11/15/2021  
 HILLSBURGH HEIGHTS INC. (BRIARWOOD DEVELOPMENTS GROUP)

**SURVEYOR'S CERTIFICATE:**  
 I HEREBY CERTIFY THAT THE BOUNDARIES OF THE LAND TO BE SUBDIVIDED AND THEIR RELATIONSHIP TO THE ADJOINING PROPERTIES ARE CORRECTLY SHOWN ON THIS PLAN  
 DATE: Jan. 30, 2022  
 RAYMOND J. SIBTHORP  
 ONTARIO LAND SURVEYORS  
 BLACK, SHOEMAKER, ROBINSON & DONALDSON LTD.  
 457 WOODLAWN ROAD WEST UNIT 101 GUELPH ONTARIO  
 TEL (519)822-1220 www.jdbarnes.com

**DRAFT PLAN OF SUBDIVISION**  
 5916 TRAFALGAR ROAD NORTH  
 (PART OF LOT 26, CONCESSION 7  
 TOWN OF ERIN  
 COUNTY OF WELLINGTON  
 FILE No: 23T-21002, Z21-09

**CANDEVCON LIMITED**  
 CONSULTING ENGINEERS AND PLANNERS  
 TEL. (905) 794-0600 FAX (905) 794-0611  
 SCALE: 1:1500 DWG. No. PL-1  
 DATE: NOV., 12th 2021 PROJECT No. W21081



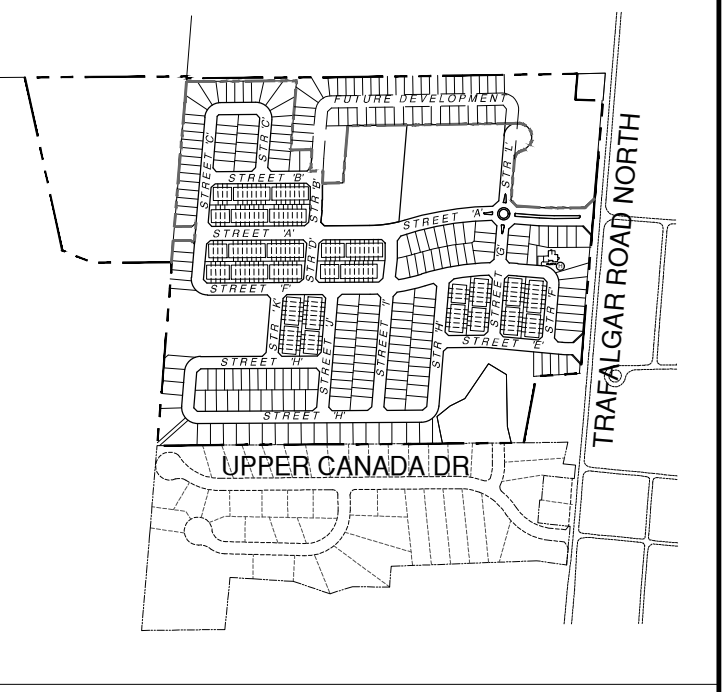
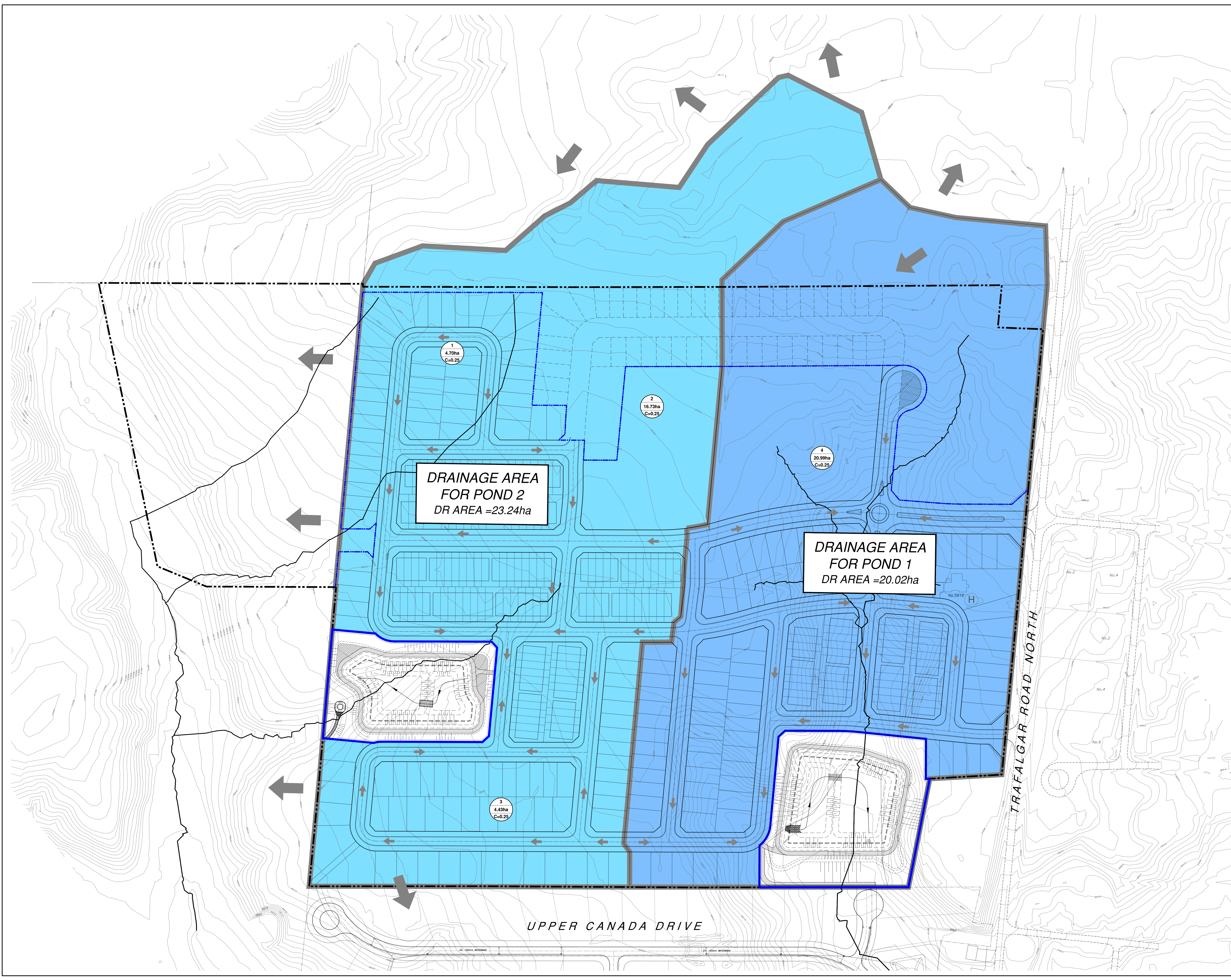

**KEY PLAN**

- LEGEND:**
- LIMIT OF SUBDIVISION
  - - - PHASING LIMIT
  - PROPOSED SWM POND DRAINAGE AREA BOUNDARY
  - ➔ OVERLAND FLOW ROUTE

**DRAINAGE AREA FOR POND 2**  
DR AREA =23.24ha

**DRAINAGE AREA FOR POND 1**  
DR AREA =20.02ha

1  
4.70ha  
C=0.25

2  
16.73ha  
C=0.25

4  
20.99ha  
C=0.25

3  
4.43ha  
C=0.25

- REFERENCE DRAWINGS:**
1. REFER TO DRAFT PLAN (PL-1) PREPARED BY CANDEVCON LIMITED FOR SUBDIVISION LAYOUT
  2. REFER TO DRAWING PS-1 FOR INFORMATION ON STORM, SANITARY & FDC

NO.	DESCRIPTION	DATE	BY

**303 CANDEVCON LIMITED**  
CONSULTING ENGINEERS AND PLANNERS  
TEL: (905) 794-0600 FAX: (905) 794-0611

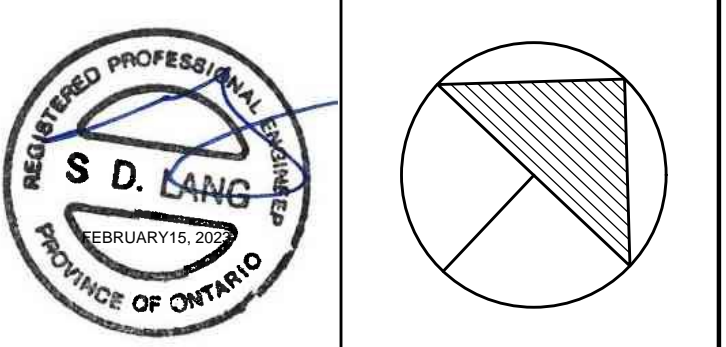

**HILLSBURGH HEIGHTS INC.**  
RESIDENTIAL SUBDIVISION  
5616 TRAFALGAR ROAD NORTH  
PART 1 OF PLAN 61R-9590  
PART OF LOT 26, CONCESSION 7  
HILLSBURGH URBAN AREA  
TOWN OF ERIN

**PREDEVELOPMENT SWM POND DRAINAGE AREA PLAN**

DRAWN BY:	E.A.M	PROJECT No.:	W21081
CHECKED BY:	S.L	DRAWING No.:	PDR-1
SCALE:	1:750	DATE:	OCT 1st, 2021



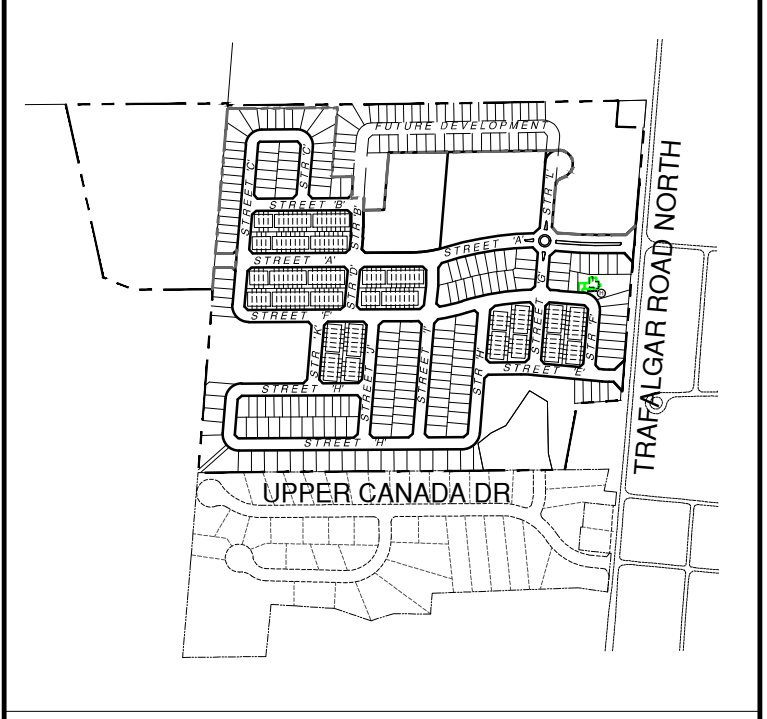
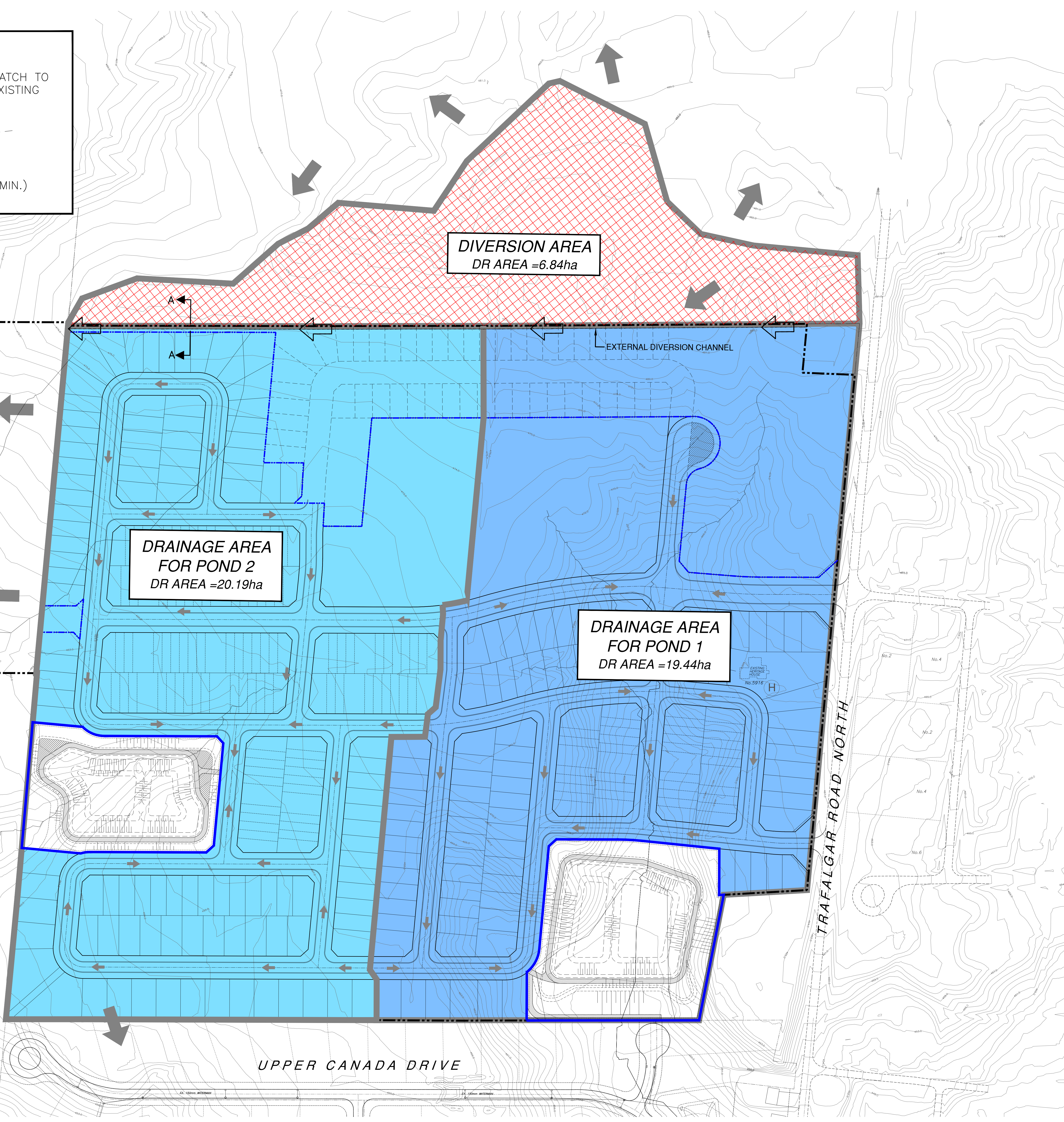
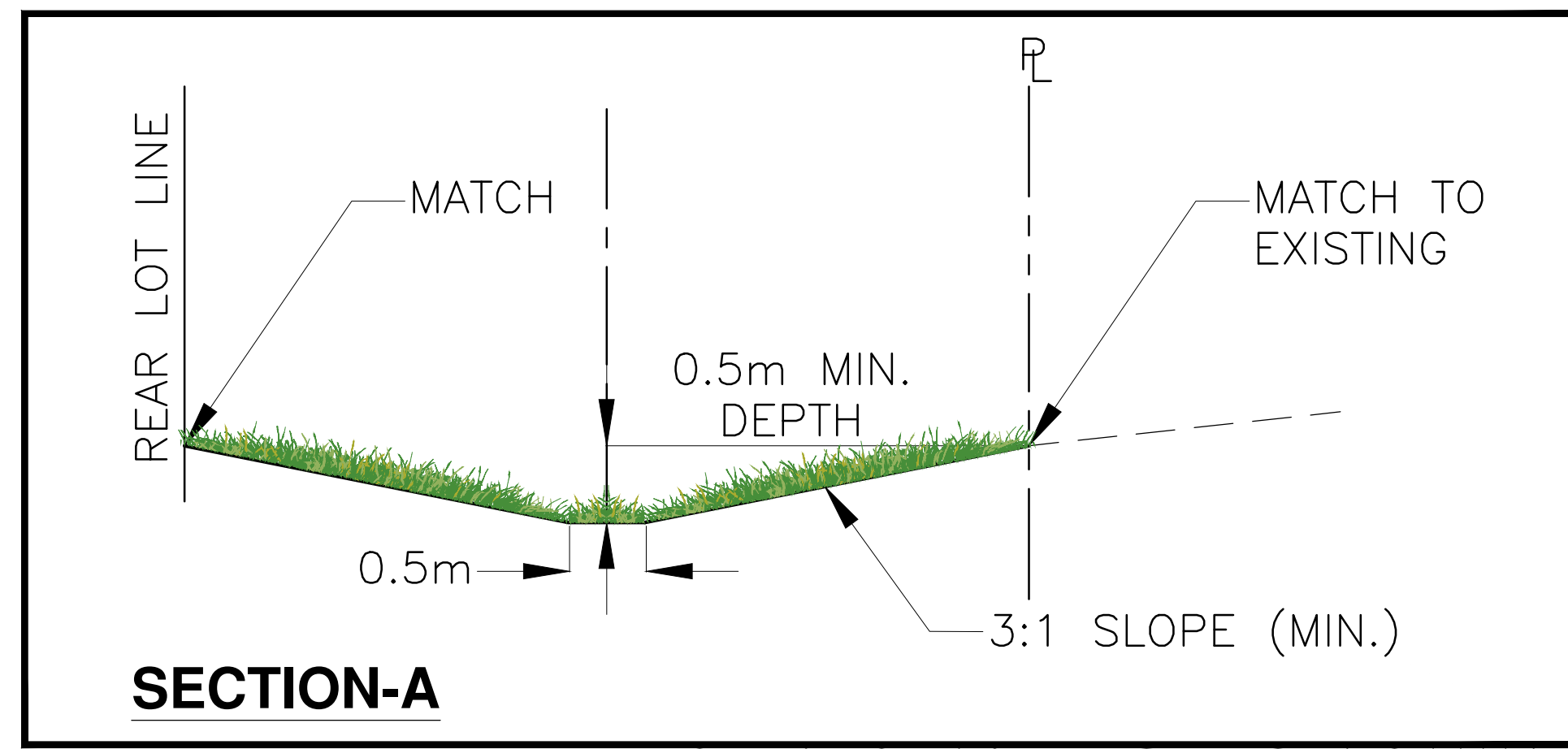

- LEGEND:**
- LIMIT OF SUBDIVISION
  - - - PHASING LIMIT
  - PROPOSED SWM POND DRAINAGE AREA BOUNDARY
  - ➔ OVERLAND FLOW ROUTE

- REFERENCE DRAWINGS:**
1. REFER TO DRAFT PLAN (PL-1) PREPARED BY CANDEVCON LIMITED FOR SUBDIVISION LAYOUT
  2. REFER TO DRAWING PS-1 FOR INFORMATION ON STORM, SANITARY & FDC

NO.	DESCRIPTION	DATE	BY

**303 CANDEVCON LIMITED**  
CONSULTING ENGINEERS AND PLANNERS  
TEL: (905) 794-0600 FAX: (905) 794-0611

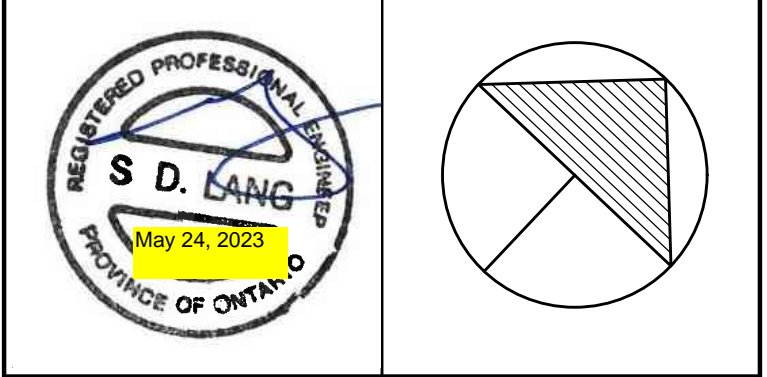

**HILLSBURGH HEIGHTS INC.**  
RESIDENTIAL SUBDIVISION  
5916 TRAFALGAR ROAD NORTH  
PART 1 OF PLAN 61R-9590  
PART OF LOT 26, CONCESSION 7  
HILLSBURGH URBAN AREA  
TOWN OF ERIN

SHEET TITLE:  
**POST DEVELOPMENT SWM POND DRAINAGE AREA PLAN**

DRAWN BY: E.A.M.	PROJECT No. W21081
CHECKED BY: S.L.	DRAWING No. PDR-2
SCALE: 1:750	DATE: MAY 29, 2023



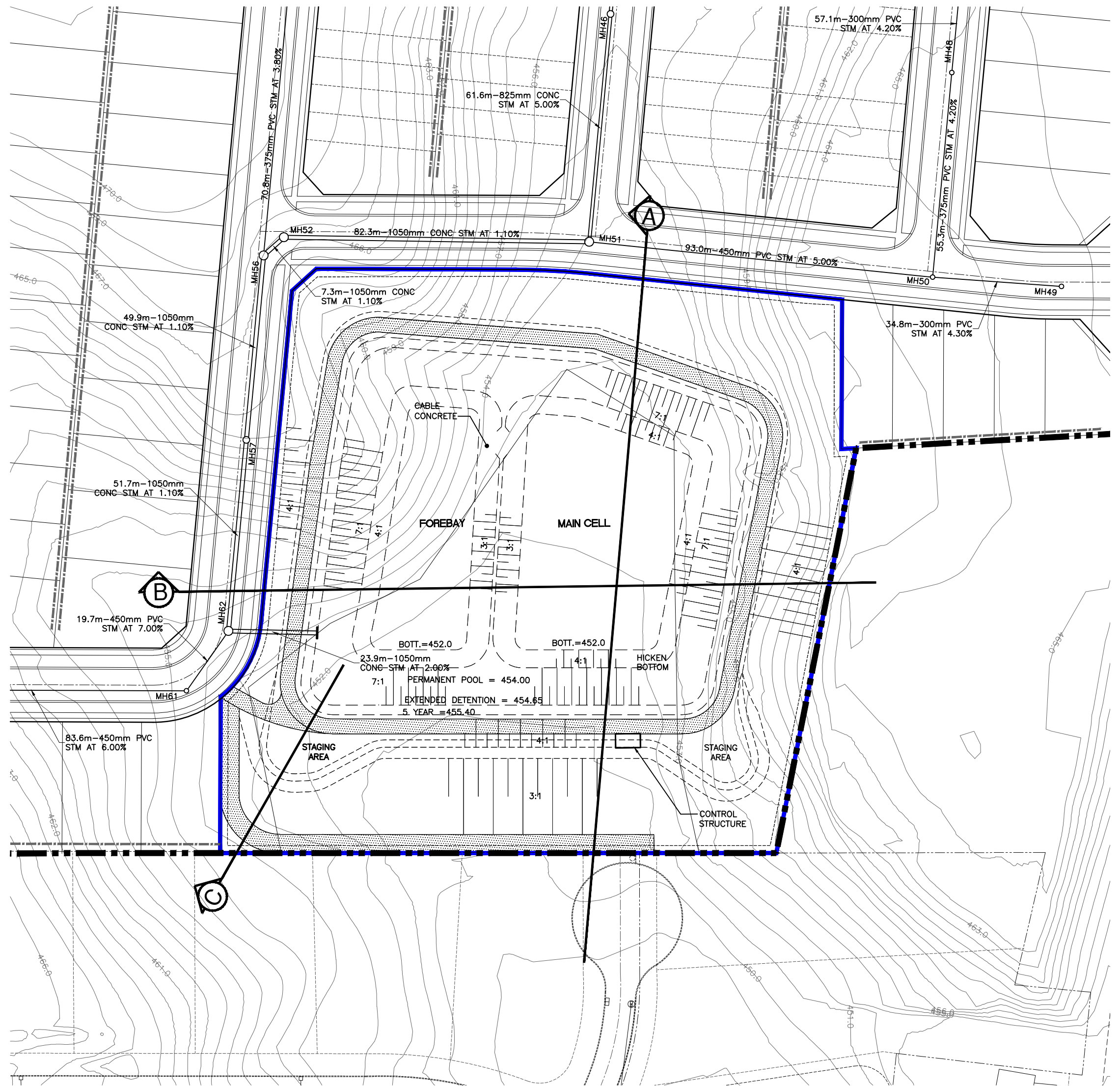

**PLAN - POND 1**  
1:1000

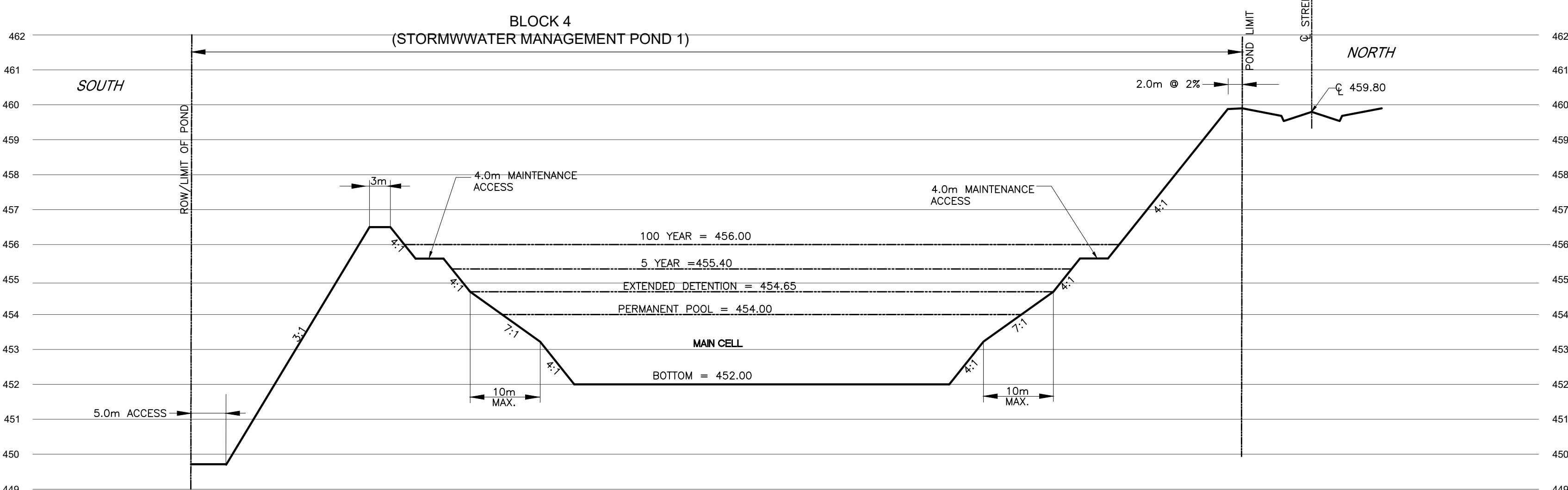

**SECTION 'A' - NORTH-SOUTH**  
H:1:500 V:1:100

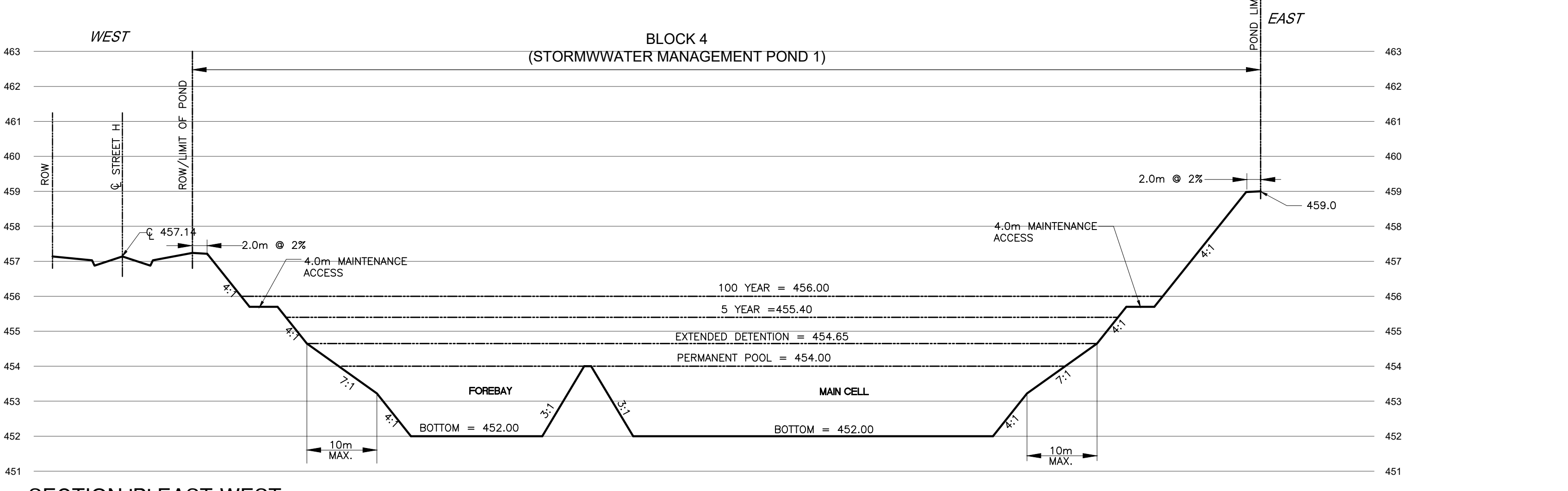

**SECTION 'B' - EAST-WEST**  
H:1:500 V:1:100

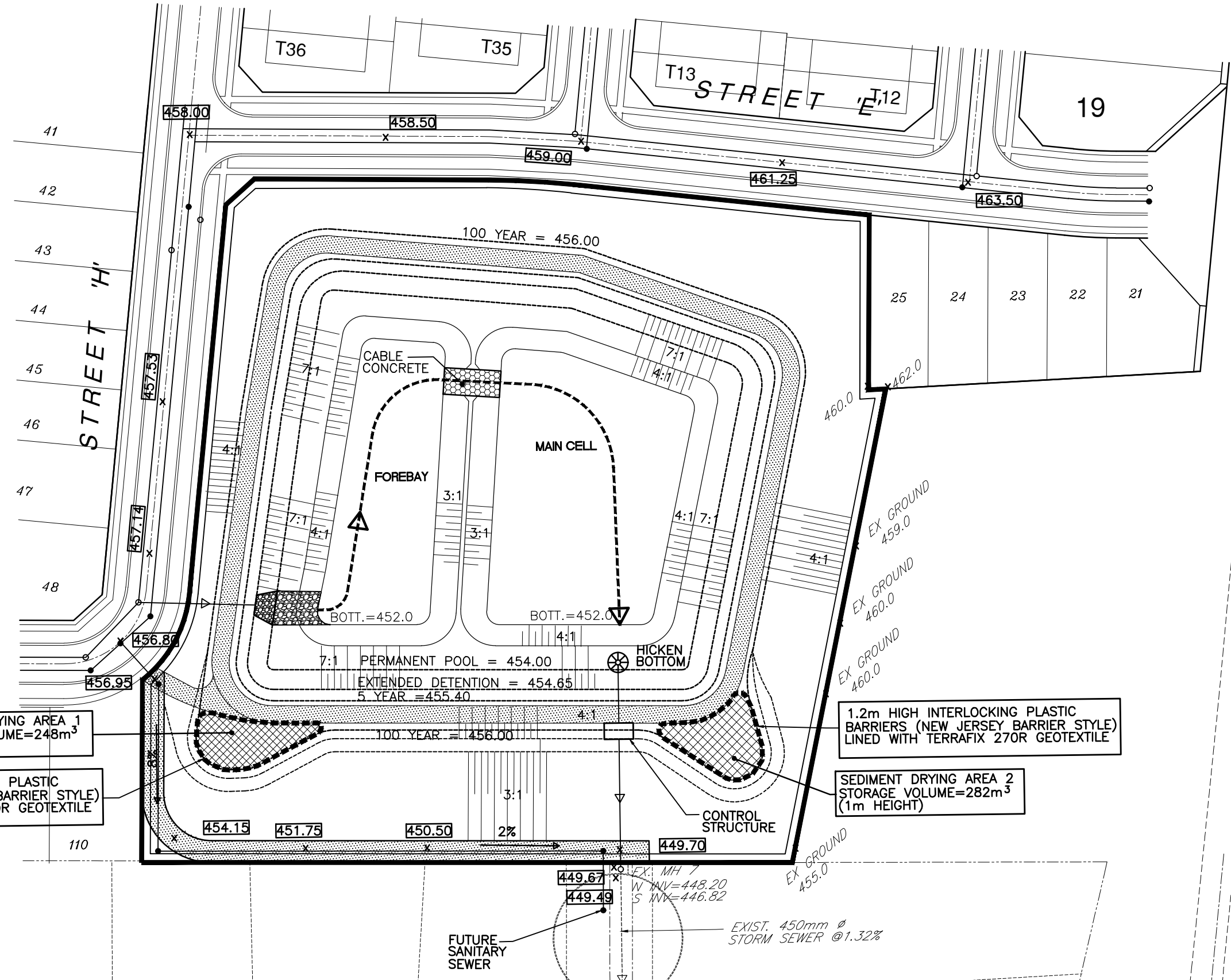

**SEDIMENT DRYING AREAS**  
1:1000

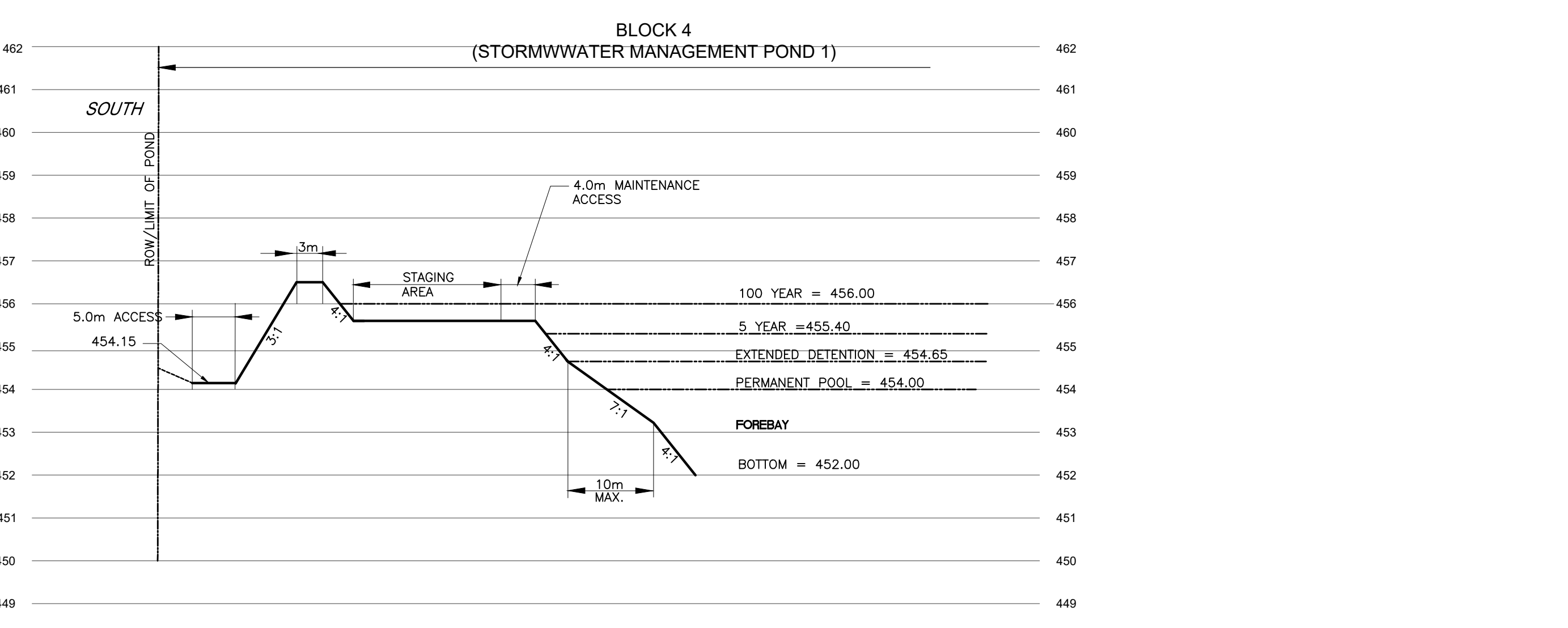

**SECTION 'C'**  
H:1:500 V:1:100

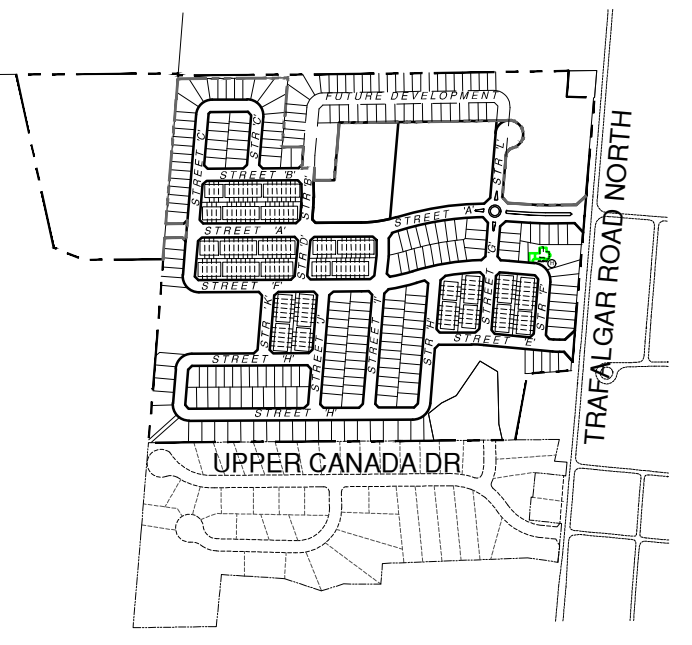

**KEY PLAN**  
1:15,000

- LEGEND:**
- OVERLAND FLOW
  - LIMIT OF POND
  - REGIONAL FLOOD LINE (2015)

- REFERENCE DRAWINGS:**
1. REFER TO DRAFT PLAN (PL-1) PREPARED BY CANDEVCON LIMITED FOR SUBDIVISION LAYOUT
  2. REFER TO DRAWING PS-1 FOR INFORMATION ON STORM SEWER.

NO.	DESCRIPTION	DATE	BY
REVISIONS			
1	SEDIMENT DRYING AREAS ADDED	2023-05-26	SL
2	FOURTH SUBMISSION	2023-02-15	SL
3	THIRD SUBMISSION	2023-02-15	SL
4	SECOND SUBMISSION	2022-07-29	SL

**CANDEVCON LIMITED**  
CONSULTING ENGINEERS AND PLANNERS  
TEL (905) 794-0600 FAX (905) 794-0611

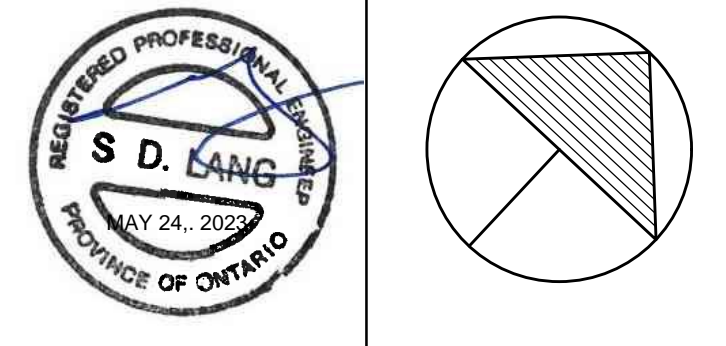

**HILLSBURGH HEIGHTS INC.**  
RESIDENTIAL SUBDIVISION  
5916 TRAFALGAR ROAD NORTH  
PART 1 OF PLAN 61R-9590  
PART OF LOT 26, CONCESSION 7  
HILLSBURGH URBAN AREA  
TOWN OF ERIN

SHEET TITLE:  
**STORM WATER MANAGEMENT - POND 1 PLAN & SECTIONS**

DRAWN BY: E.A.M	PROJECT No. W21081
CHECKED BY: S.L	DRAWING No.
SCALE: AS NOTED	<b>SWM-1</b>
DATE: OCT 1st, 2021	



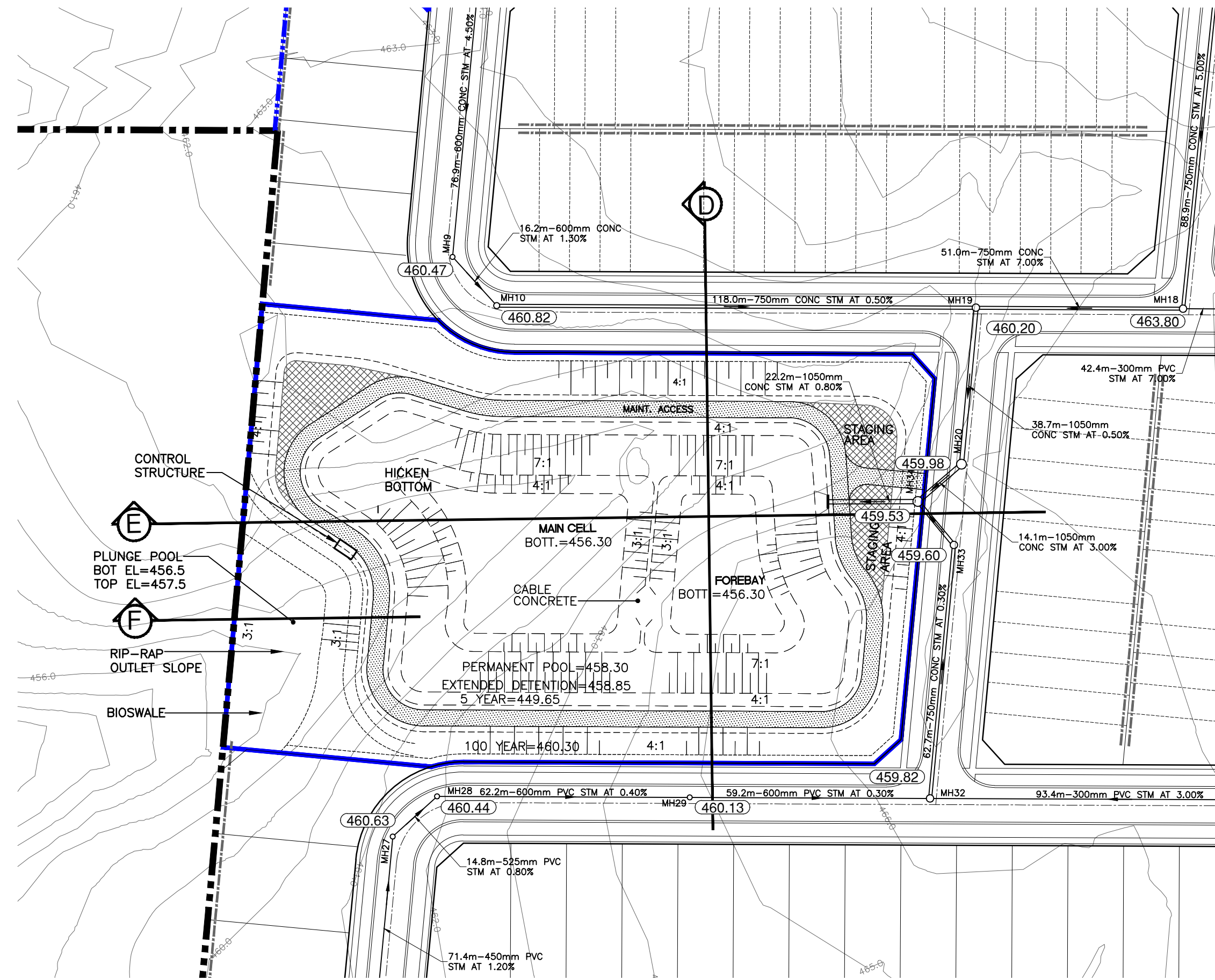

**PLAN - POND 2**  
1:1000

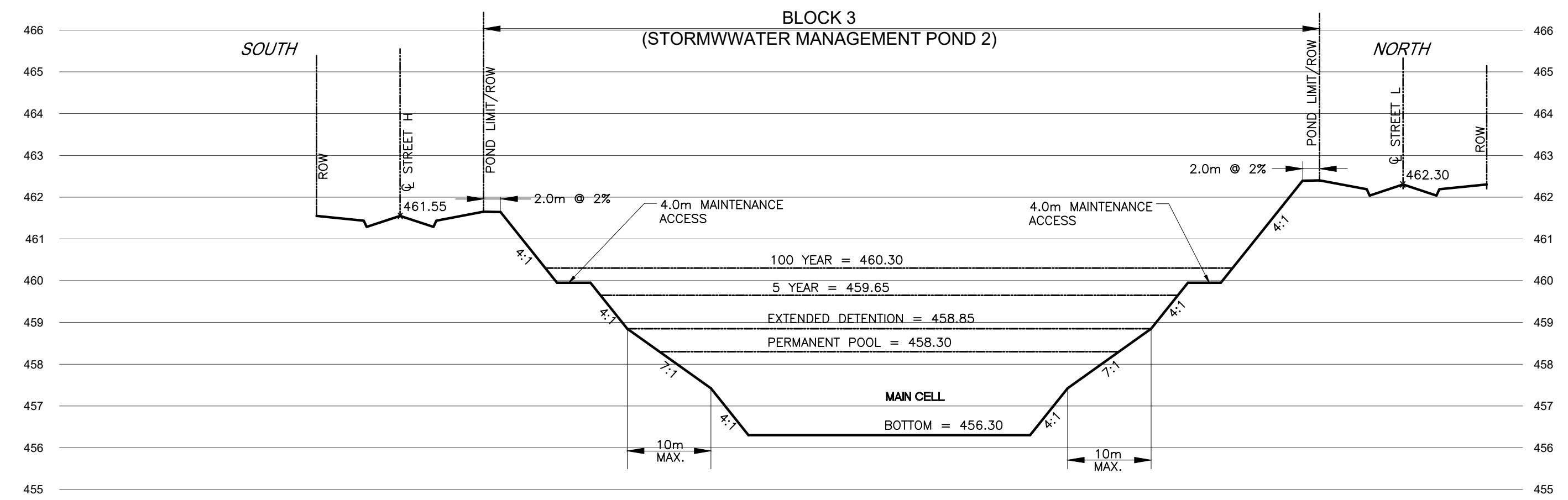

**SECTION 'D' NORTH-SOUTH**  
H-1:500 V-1:100

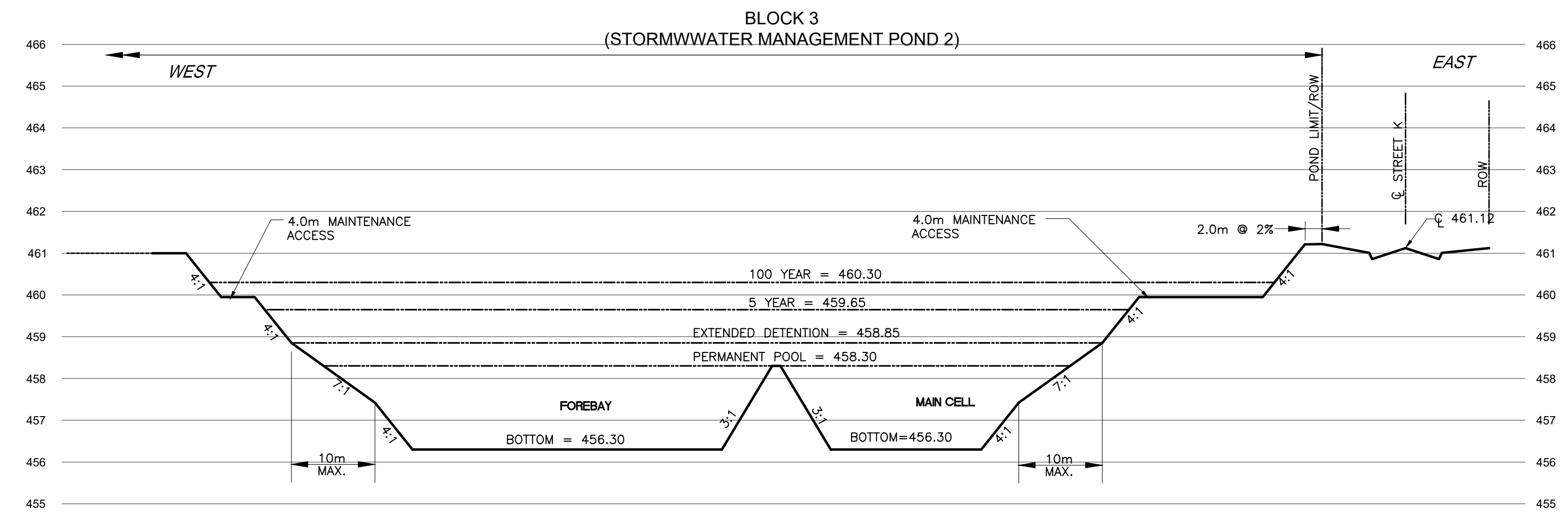

**SECTION 'E' EAST-WEST**  
H-1:500 V-1:100

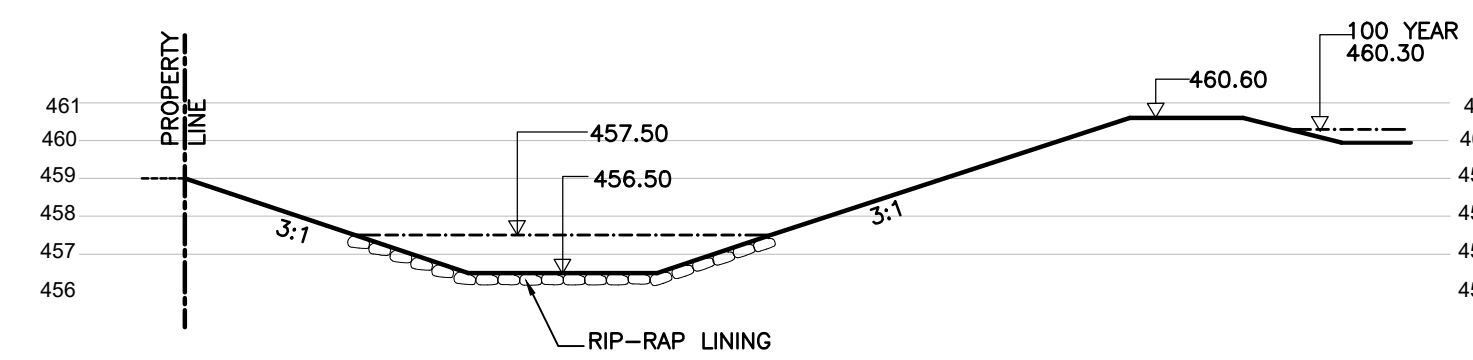

**SECTION F**  
H-1:200 V-1:200

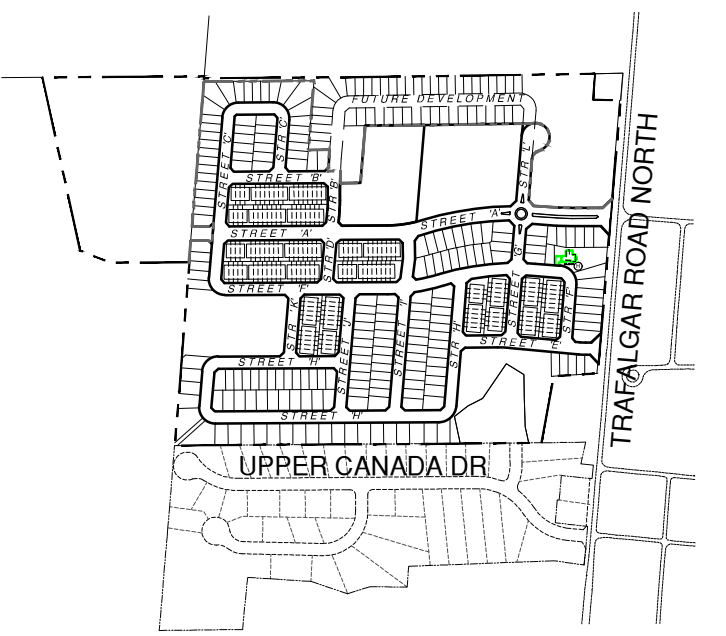

**KEY PLAN**  
1:15,000

**LEGEND:**

- OVERLAND FLOW
- LIMIT OF POND
- REGIONAL FLOOD LINE (2015)

**REFERENCE DRAWINGS:**

1. REFER TO DRAFT PLAN (PL-1) PREPARED BY CANDEVCON LIMITED FOR SUBDIVISION LAYOUT
2. REFER TO DRAWING PS-1 FOR INFORMATION ON STORM SEWER.

NO.	DESCRIPTION	DATE	BY

**REVISIONS**

**CD CANDEVCON LIMITED**  
CONSULTING ENGINEERS AND PLANNERS  
TEL (905) 794-0600 FAX (905) 794-0611

**REGISTERED PROFESSIONAL ENGINEER**  
**S. D. LANG**  
MAY 24, 2023  
PROVINCE OF ONTARIO

**HILLSBURGH HEIGHTS INC.**  
RESIDENTIAL SUBDIVISION  
**5916 TRAFALGAR ROAD NORTH**  
PART 1 OF PLAN 61R-9590  
PART OF LOT 26, CONCESSION 7  
HILLSBURGH URBAN AREA  
TOWN OF ERIN

SHEET TITLE:  
**STORM WATER MANAGEMENT - POND 2 PLAN & SECTIONS**

DRAWN BY:	E.A.M	PROJECT No.	W21081
CHECKED BY:	S.L	DRAWING No.	
SCALE:	AS NOTED		
DATE:	OCT 1st, 2021		

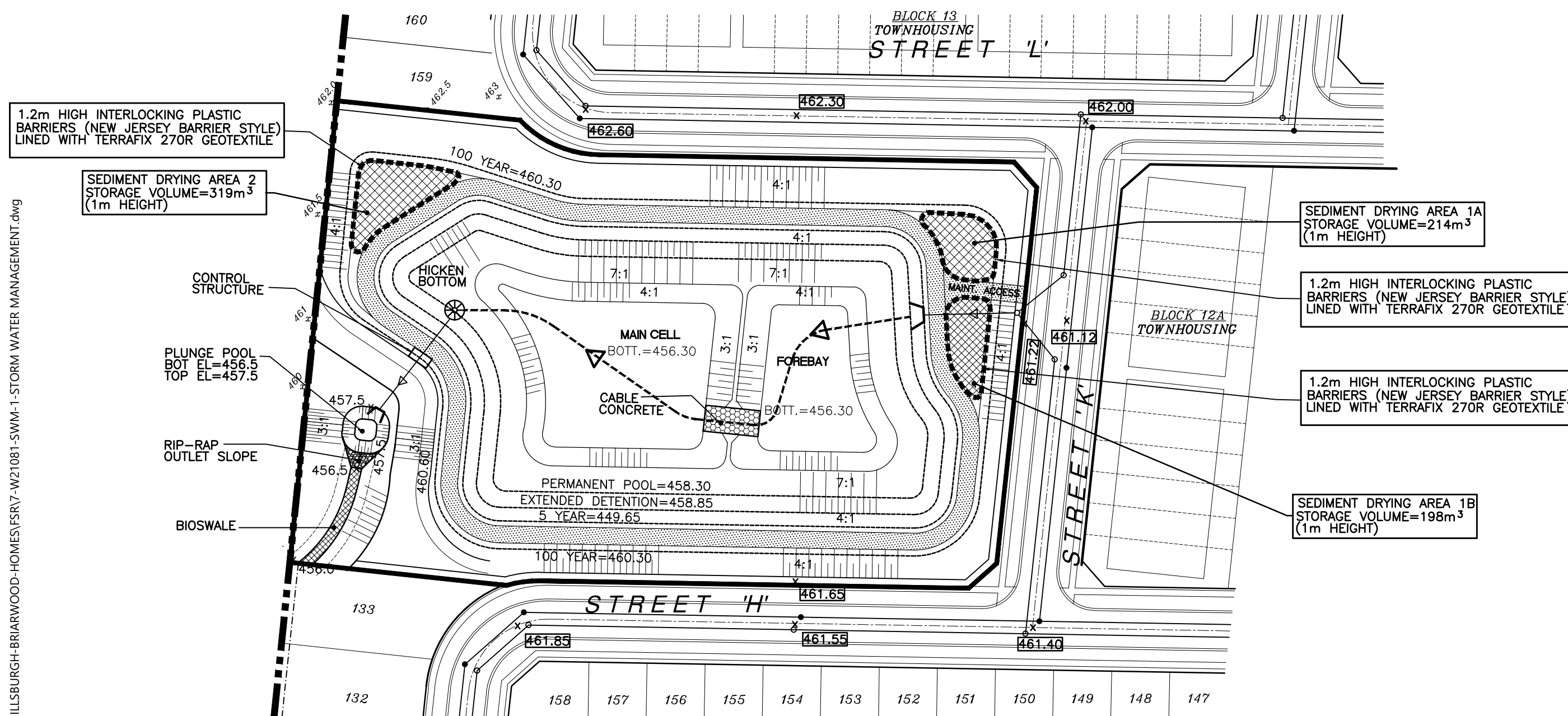

**SEDIMENT DRYING AREAS**  
1:1000