

**LEGEND**

- PROPERTY LINE
- - - EXISTING CONTOUR
- 412.00 — HIGH GROUNDWATER ELEVATION CONTOUR
- MATCH EX. — MATCH TO EXISTING ELEVATION
- x 413.21 — PROPOSED ELEVATION
- 412.31 — EXISTING ELEVATION
- 411.70 — WATER TABLE ELEVATION
- x 413.21sw — PROPOSED  $\frac{1}{2}$  OF SWALE ELEVATION
- 8.5% — PROPOSED SLOPE
- — PROPOSED DIRECTION OF FLOW
- — EXISTING DIRECTION OF FLOW
- PROPOSED 3:1 SLOPE
- (415.0) — PROPOSED HOUSE ELEVATION (FRONT/BACK)
- 150-300mm $\phi$  RIP RAP

NOTE: HIGH GROUNDWATER ELEVATIONS OBTAINED FROM CHUNG & VANDER DOELEN ENGINEERING LTD. REPORT DATED NOVEMBER 2018.



**NOT FOR CONSTRUCTION**

BENCHMARK - ELEVATION  
TOPOGRAPHIC SURVEY INFORMATION BY IBI GROUP SURVEYORS ON SEPTEMBER 19, 2017.

LOCATION DESCRIPTION:  
798459 - TWO STOREY RED BRICK HOUSE ON EAST SIDE OF HWY 24, 81.5 M SOUTH OF WEST ACT OF HWYS 24 AND 25 AT OSPRINGE, 1.3 KM NORTH OF ERIN 1ST LINE AND 10.1 M EAST OF CENTRELINE OF HWY 24. TABLE IS SET HORIZONTALLY IN NORTH FACE OF STONE FOUNDATION, 2.46 M EAST OF N.W. CORNER, 86 CM BELOW BRICKWORK AND 33 CM ABOVE GROUND LEVEL. ELEVATION: 409.903

#	DATE	BY	DESCRIPTION
1	2021-06-28	K.C.	SECOND SUBMISSION TO TOWN OF ERIN

REVISIONS

APPROVALS

**IBI GROUP**  
101 - 410 Albert Street  
Waterloo ON N2L 3V3 Canada  
tel 519 585 2255 fax 519 585 2269  
ibigroup.com

OSPRINGE SETTLEMENT AREA  
COUNTY OF WELLINGTON

DRAFT PLAN OF SUBDIVISION  
OSPRINGE DEVELOPMENT

FUNCTIONAL GRADING PLAN

DESIGNED BY: P. CLOUTIER  
DRAWN BY: P. CLOUTIER  
CHECKED BY: K. COBBE  
DATE: 2019-10-04

SCALE HORIZ: 1:500  
SCALE VERT: 1:100  
FILE NUMBER: 111618  
SHEET NUMBER: GP

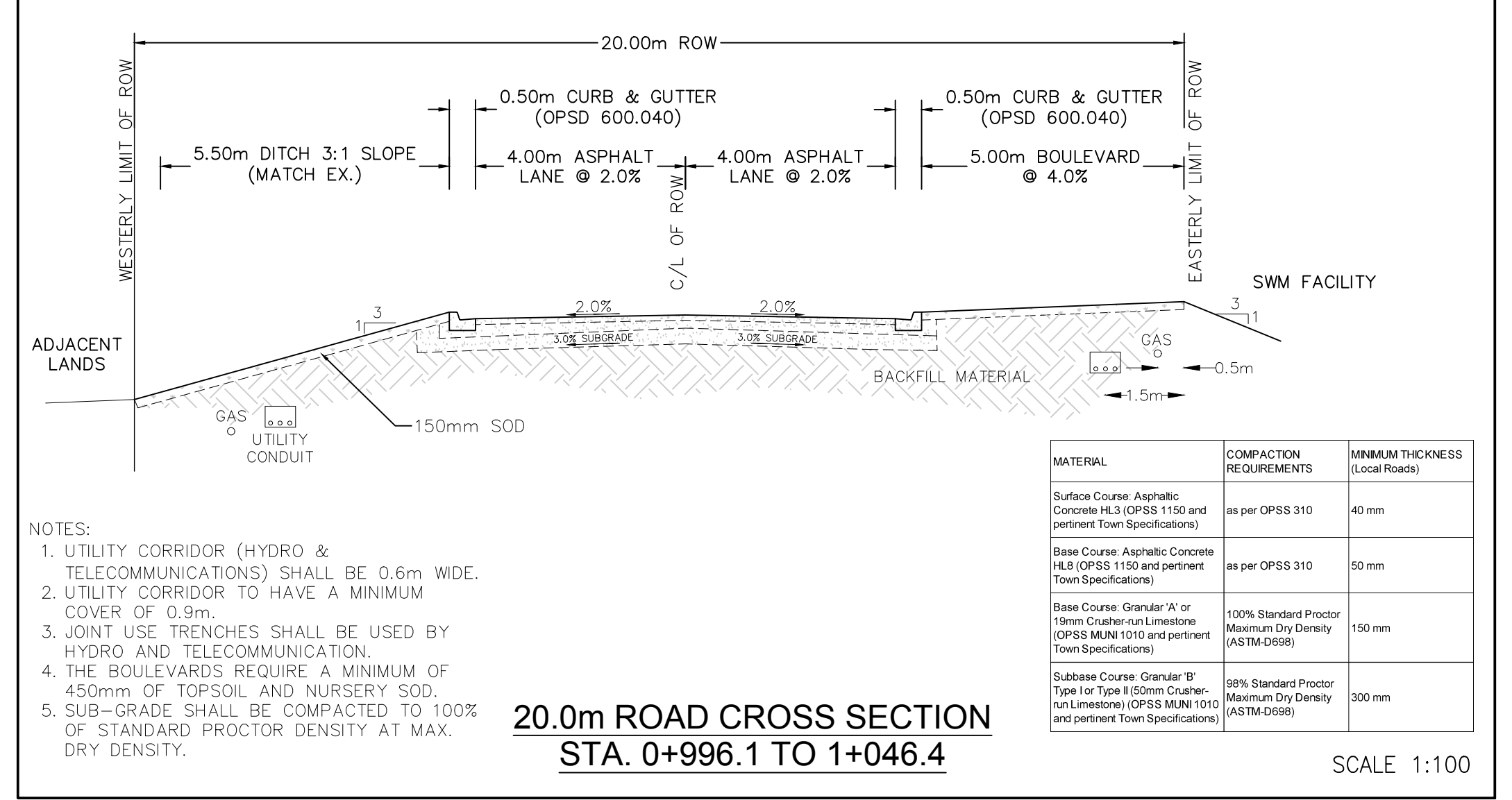
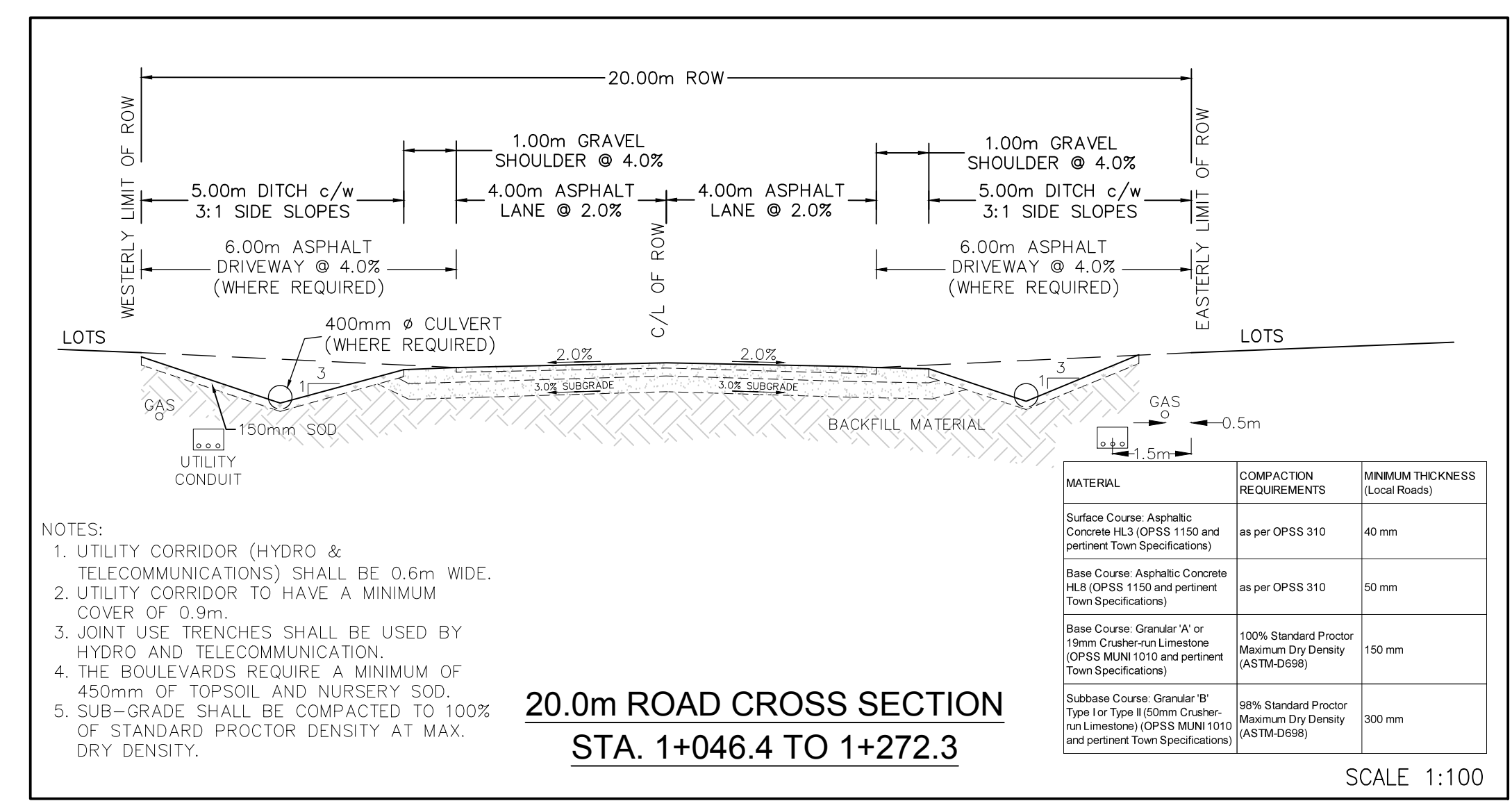

NOTE: STORMWATER OUTLET FROM ALL ROOF DRAINS AND SUMP PUMP DRAINS SHALL BE DIRECTED TOWARDS THE PROPOSED INTERNAL ROAD.