

Water quality sampling results to date are summarized on the attached **Table 2**. We note that the October 2nd samples analysis results are not yet available, those results will be provided in the next monthly report.

Observations

Groundwater-surface water interaction is summarized as follows:

- Water levels collected to date at DP1 show that the water table along the southeast (downgradient) edge of the pond is significantly lower than the pond (approx. 1.5 m difference), indicating recharge conditions and groundwater flow away from the pond in this location.
- Water levels at DP2 are observed to be higher than the pond level under spring conditions. This indicates groundwater flow toward and into the pond in this area (likely extending along the northwest edge) at that time. Recent water levels indicate that summer evapotranspiration in this area may naturally lower the groundwater table to (or slightly below) the pond level.
- Water levels collected at DP3 indicate that the water table is naturally below the pond level, indicating recharge conditions and groundwater flow away from the pond in this area (likely extending from the creek inflow location to the dam).
- The pond was lowered from mid-May to early June to allow initial construction. A coffer dam was installed in early June, which allowed pond levels to be reestablished and maintained slightly below spring levels over the construction period. In water works are reported to be substantially complete, and on September 18th the pond level was allowed to rise to a more “typical” seasonal level.
- Groundwater levels surrounding the pond responded to the pond level increase through mid to late September. Current groundwater levels appear to correspond to “typical” conditions in the area of the pond.
- To date water table changes associated with construction are relatively minor. No significant changes in water quality are noted.

Summary

Construction activities have not resulted in any significant changes to groundwater conditions to date. We note that construction works are nearing completion, and the pond levels have returned to more “typical” seasonal levels. The program schedule also includes approximately 1 month of post-construction water level and quality monitoring to continue to track potential changes.

Sincerely,



Andrew Pentney, P.Geol.
Senior Hydrogeologist
Groundwater Science Corp.

Attached: Figure 1, Figure 2
 Table 1, Table 2

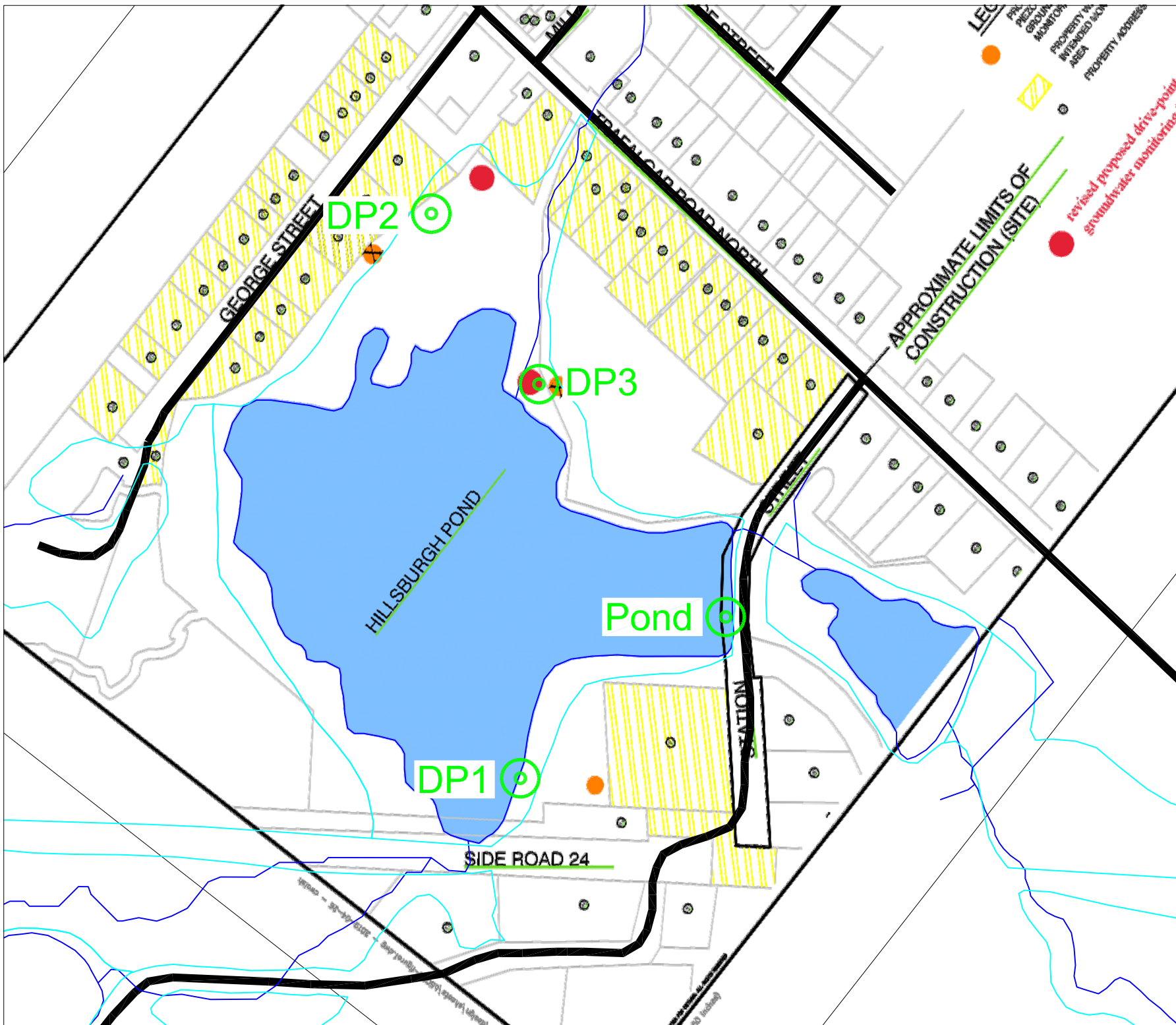

Legend
 ○ DP1 Dam monitor

Figure 1
 Station Street Dam
 Monitoring Network

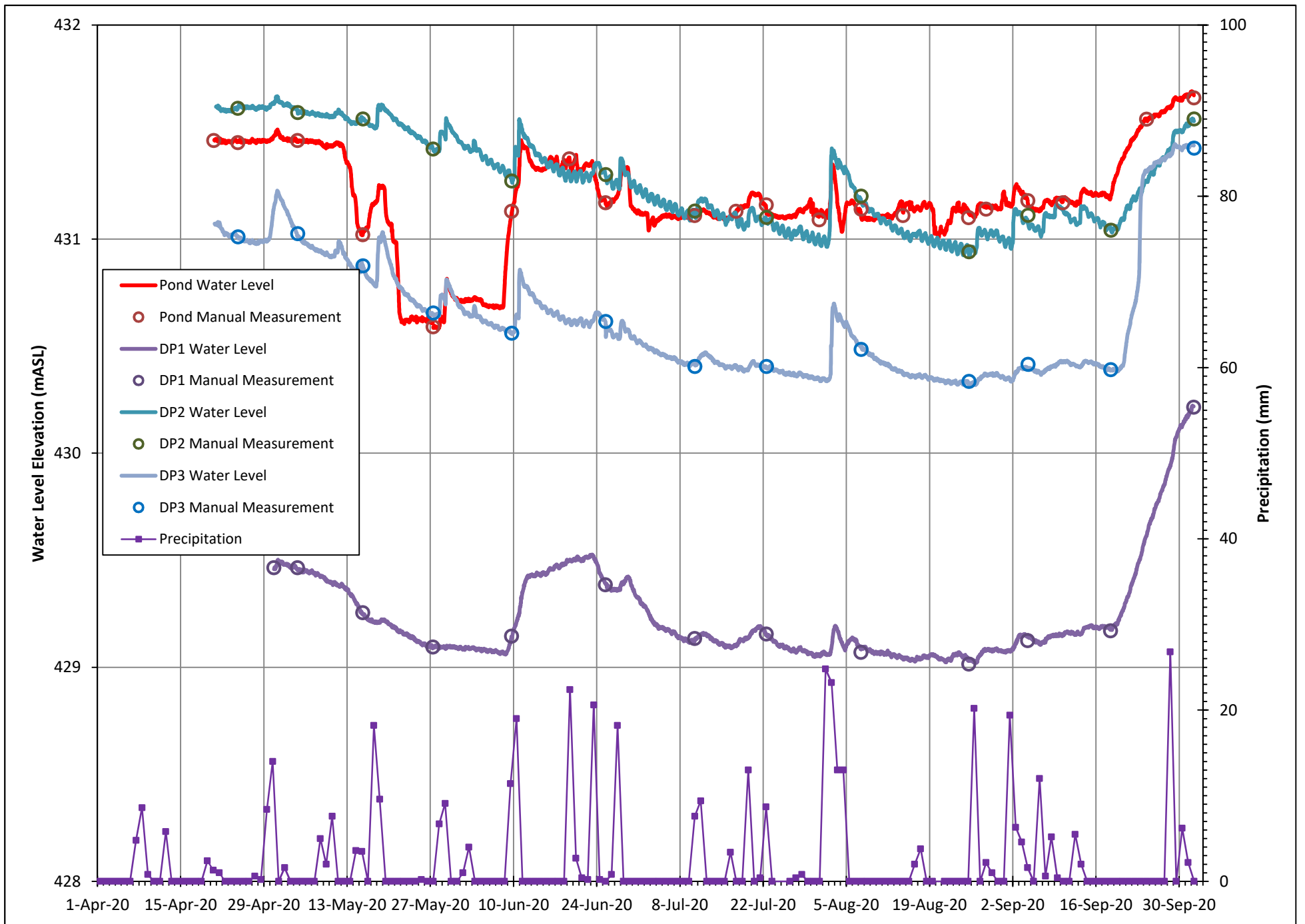

Figure 2: Water Level Hydrograph

| Location | Type | As Installed | | | Elevations | |
|--|---------------|------------------------|--------------------|---------------------|--------------------------|-----------------------|
| | | Total Depth (mBTOP) | Stick-Up (mAGS) | Screen Lenth (m) | Ground Surface (mASL) | Top of Pipe (mASL) |
| Pond | stilling well | 1.90 | 1.90 | 1.00 | 430.46 | 432.36 |
| DP1 | piezometer | 4.09 | 1.22 | 0.30 | 431.57 | 432.79 |
| DP2 | piezometer | 2.21 | 0.42 | 0.30 | 431.62 | 432.13 |
| DP3 | piezometer | 2.84 | 1.26 | 0.30 | 431.36 | 432.70 |
| Notes: mBTOP = metres below top of pipe mAGS = metres above ground surface mASL = metres above sea level | | | | | | |

| Sample Location: | | POND | | | | | | | | | | |
|-----------------------------|-------|-------------|------------|-------------|------------|-------------|-------------|-------------|------------|-------------|------------|-------------|
| Date: | | 24-Apr-2020 | 4-May-2020 | 27-May-2020 | 9-Jun-2020 | 25-Jun-2020 | 10-Jul-2020 | 22-Jul-2020 | 7-Aug-2020 | 25-Aug-2020 | 4-Sep-2020 | 18-Sep-2020 |
| Parameter | Units | Water | Water | Water | Water | Water | Water | Water | Water | Water | Water | Water |
| Anions and Nutrients | | | | | | | | | | | | |
| Bromide (Br) | mg/L | <0.10 | <0.10 | <0.10 | <0.10 | <0.10 | <0.10 | <0.10 | <0.10 | <0.10 | <0.10 | <0.10 |
| Chloride (Cl) | mg/L | 24.7 | 25.9 | 24.4 | 22.3 | 23.9 | 21.8 | 21.4 | 22.9 | 23.1 | 23.1 | 23.9 |
| Fluoride (F) | mg/L | 0.045 | 0.047 | 0.050 | 0.046 | 0.048 | 0.052 | 0.051 | 0.054 | 0.051 | 0.053 | 0.053 |
| Nitrate (as N) | mg/L | 3.20 | 3.03 | 3.22 | 3.09 | 2.76 | 2.14 | 1.93 | 2.22 | 2.62 | 2.38 | 3.33 |
| Nitrite (as N) | mg/L | 0.014 | 0.020 | 0.024 | 0.026 | 0.042 | 0.038 | 0.029 | 0.023 | 0.035 | 0.019 | 0.019 |
| Sulfate (SO4) | mg/L | 18.1 | 18.7 | 18.7 | 20.5 | 18.3 | 17.8 | 17.0 | 18.7 | 18.1 | 17.8 | 19.4 |
| Total Metals | | | | | | | | | | | | |
| Aluminum (Al)-Total | mg/L | 0.0680 | 0.2350 | 0.1120 | 0.0317 | 0.0447 | 0.0233 | 0.0307 | 0.0483 | 0.0688 | 0.0551 | 0.0513 |
| Antimony (Sb)-Total | mg/L | <0.00010 | 0.00021 | <0.00010 | <0.00010 | <0.00010 | <0.00010 | <0.00010 | <0.00010 | <0.00010 | <0.00010 | <0.00010 |
| Arsenic (As)-Total | mg/L | 0.00025 | 0.00039 | 0.00038 | 0.00028 | 0.00036 | 0.00043 | 0.00043 | 0.00042 | 0.00037 | 0.00038 | 0.00028 |
| Barium (Ba)-Total | mg/L | 0.0342 | 0.0416 | 0.0319 | 0.0404 | 0.0643 | 0.0634 | 0.0507 | 0.0508 | 0.0514 | 0.0456 | 0.0446 |
| Beryllium (Be)-Total | mg/L | <0.00010 | <0.00010 | <0.00010 | <0.00010 | <0.00010 | <0.00010 | <0.00010 | <0.00010 | <0.00010 | <0.00010 | <0.00010 |
| Bismuth (Bi)-Total | mg/L | <0.000050 | <0.000050 | <0.000050 | <0.000050 | <0.000050 | <0.000050 | <0.000050 | <0.000050 | <0.000050 | <0.000050 | 0.000054 |
| Boron (B)-Total | mg/L | <0.010 | <0.010 | <0.010 | <0.010 | <0.010 | <0.010 | <0.010 | <0.010 | <0.010 | <0.010 | <0.010 |
| Cadmium (Cd)-Total | mg/L | 0.0000076 | 0.0000275 | 0.0000090 | <0.0000050 | <0.0000050 | <0.0000050 | <0.0000050 | <0.0000050 | <0.0000050 | <0.0000050 | <0.0000050 |
| Calcium (Ca)-Total | mg/L | 69.2 | 73.5 | 60.1 | 62.0 | 65.4 | 61.4 | 63.1 | 65.9 | 67.2 | 67.1 | 70.0 |
| Cesium (Cs)-Total | mg/L | <0.000010 | 0.000022 | <0.000010 | <0.000010 | <0.000010 | <0.000010 | <0.000010 | <0.000010 | <0.000010 | <0.000010 | <0.000010 |
| Chromium (Cr)-Total | mg/L | <0.00050 | 0.0008 | <0.00050 | <0.00050 | <0.00050 | <0.00050 | <0.00050 | <0.00050 | <0.00050 | <0.00050 | <0.00050 |
| Cobalt (Co)-Total | mg/L | <0.00010 | 0.00013 | <0.00010 | <0.00010 | <0.00010 | <0.00010 | <0.00010 | <0.00010 | <0.00010 | <0.00010 | <0.00010 |
| Copper (Cu)-Total | mg/L | 0.00060 | 0.00110 | 0.00066 | <0.00050 | <0.00050 | <0.00050 | <0.00050 | <0.00050 | <0.00050 | 0.00089 | 0.00157 |
| Iron (Fe)-Total | mg/L | 0.108 | 0.377 | 0.179 | 0.083 | 0.145 | 0.119 | 0.083 | 0.109 | 0.100 | 0.093 | 0.083 |
| Lead (Pb)-Total | mg/L | 0.000297 | 0.001100 | 0.000572 | 0.000131 | 0.000200 | 0.000139 | 0.000100 | 0.000164 | 0.000208 | 0.000189 | 0.000175 |
| Lithium (Li)-Total | mg/L | 0.0021 | 0.0015 | 0.0018 | 0.0015 | 0.0018 | 0.0014 | 0.0015 | 0.0017 | 0.0018 | 0.0015 | 0.0019 |
| Magnesium (Mg)-Total | mg/L | 21.2 | 20.3 | 21.0 | 21.9 | 21.4 | 20.6 | 22.0 | 19.9 | 21.1 | 19.9 | 21.1 |
| Manganese (Mn)-Total | mg/L | 0.0122 | 0.0394 | 0.0211 | 0.0157 | 0.0288 | 0.0301 | 0.0230 | 0.0256 | 0.0175 | 0.0160 | 0.0154 |
| Molybdenum (Mo)-Total | mg/L | 0.000263 | 0.000294 | 0.000271 | 0.000270 | 0.000324 | 0.000369 | 0.000363 | 0.000273 | 0.000289 | 0.000261 | 0.000250 |
| Nickel (Ni)-Total | mg/L | <0.00050 | <0.00050 | <0.00050 | <0.00050 | <0.00050 | <0.00050 | <0.00050 | <0.00050 | <0.00050 | <0.00050 | <0.00050 |
| Phosphorus (P)-Total | mg/L | <0.050 | <0.050 | <0.050 | <0.050 | <0.050 | <0.050 | <0.050 | <0.050 | <0.050 | <0.050 | <0.050 |
| Potassium (K)-Total | mg/L | 1.09 | 1.04 | 1.05 | 1.00 | 1.05 | 0.85 | 0.97 | 1.03 | 0.96 | 1.07 | 1.00 |
| Rubidium (Rb)-Total | mg/L | 0.00071 | 0.00099 | 0.00083 | 0.00077 | 0.00084 | 0.00073 | 0.00087 | 0.00093 | 0.00092 | 0.00097 | 0.00079 |
| Selenium (Se)-Total | mg/L | 0.000141 | 0.000149 | 0.000166 | 0.000113 | 0.000133 | 0.000114 | 0.000132 | 0.000128 | 0.000152 | 0.000119 | 0.000117 |
| Silicon (Si)-Total | mg/L | 3.82 | 3.65 | 4.32 | 4.34 | 4.13 | 4.36 | 4.51 | 4.95 | 4.63 | 4.41 | 4.50 |
| Silver (Ag)-Total | mg/L | <0.000050 | <0.000050 | <0.000050 | <0.000050 | <0.000050 | <0.000050 | <0.000050 | <0.000050 | <0.000050 | <0.000050 | <0.000050 |
| Sodium (Na)-Total | mg/L | 11.7 | 11.3 | 11.0 | 10.5 | 10.9 | 9.1 | 9.8 | 10.0 | 10.0 | 9.5 | 10.0 |
| Strontium (Sr)-Total | mg/L | 0.117 | 0.124 | 0.111 | 0.109 | 0.118 | 0.110 | 0.111 | 0.112 | 0.117 | 0.110 | 0.113 |
| Sulfur (S)-Total | mg/L | 7.01 | 6.42 | 6.63 | 7.43 | 6.53 | 6.05 | 6.15 | 6.69 | 6.72 | 6.17 | 6.92 |
| Tellurium (Te)-Total | mg/L | <0.00020 | <0.00020 | <0.00020 | <0.00020 | <0.00020 | <0.00020 | <0.00020 | <0.00020 | <0.00020 | <0.00020 | <0.00020 |
| Thallium (Tl)-Total | mg/L | <0.000010 | <0.000010 | <0.000010 | <0.000010 | <0.000010 | <0.000010 | <0.000010 | <0.000010 | <0.000010 | <0.000010 | <0.000010 |
| Thorium (Th)-Total | mg/L | <0.00010 | <0.00010 | <0.00010 | <0.00010 | <0.00010 | <0.00010 | <0.00010 | <0.00010 | <0.00010 | <0.00010 | <0.00010 |
| Tin (Sn)-Total | mg/L | 0.00028 | 0.00025 | <0.00010 | <0.00010 | <0.00010 | <0.00010 | <0.00010 | <0.00010 | <0.00010 | <0.00010 | <0.00010 |
| Titanium (Ti)-Total | mg/L | 0.00318 | 0.00842 | 0.00419 | 0.00112 | 0.00171 | 0.00087 | <0.00080 | 0.00146 | 0.00232 | 0.00165 | 0.00163 |
| Tungsten (W)-Total | mg/L | <0.00010 | <0.00010 | <0.00010 | <0.00010 | <0.00010 | <0.00010 | <0.00010 | <0.00010 | <0.00010 | <0.00010 | <0.00010 |
| Uranium (U)-Total | mg/L | 0.000524 | 0.000488 | 0.000517 | 0.000494 | 0.000501 | 0.000540 | 0.000557 | 0.000532 | 0.000558 | 0.000499 | 0.000481 |
| Vanadium (V)-Total | mg/L | <0.00050 | 0.00086 | 0.00078 | <0.00050 | 0.00053 | 0.00064 | 0.00058 | 0.00051 | 0.00063 | 0.00054 | <0.00050 |
| Zinc (Zn)-Total | mg/L | 0.0139 | 0.0865 | 0.0031 | <0.0030 | <0.0030 | <0.0030 | <0.0030 | <0.0030 | <0.0030 | 0.0237 | <0.0030 |
| Zirconium (Zr)-Total | mg/L | <0.00020 | <0.00020 | <0.00020 | <0.00020 | <0.00020 | <0.00020 | <0.00020 | <0.00020 | <0.00020 | <0.00020 | <0.00020 |

Table 2: Water Quality Results Summary

| Sample Location: | | DP1 | | | | | | | | | |
|-----------------------------|-------|------------|-------------|------------|-------------|-------------|-------------|------------|-------------|------------|-------------|
| Date: | | 4-May-2020 | 27-May-2020 | 9-Jun-2020 | 25-Jun-2020 | 10-Jul-2020 | 22-Jul-2020 | 7-Aug-2020 | 25-Aug-2020 | 4-Sep-2020 | 18-Sep-2020 |
| Parameter | Units | Water | Water | Water | Water | Water | Water | Water | Water | Water | Water |
| Anions and Nutrients | | | | | | | | | | | |
| Bromide (Br) | mg/L | <0.10 | <0.10 | <0.10 | <0.10 | <0.10 | <0.10 | <0.10 | <0.10 | <0.10 | <0.10 |
| Chloride (Cl) | mg/L | 26.6 | 30.1 | 36 | 26.9 | 27.2 | 28.4 | 28.1 | 28.6 | 28.9 | 28.6 |
| Fluoride (F) | mg/L | 0.050 | 0.041 | 0.037 | 0.048 | 0.058 | 0.052 | 0.054 | 0.05 | 0.048 | 0.045 |
| Nitrate (as N) | mg/L | 3.070 | 2.72 | 1.17 | 2.5 | 1.29 | 1.58 | 3.29 | 0.41 | 2.48 | 2.69 |
| Nitrite (as N) | mg/L | <0.010 | <0.010 | <0.010 | <0.010 | <0.010 | <0.010 | <0.010 | <0.010 | <0.010 | <0.010 |
| Sulfate (SO4) | mg/L | 18.4 | 16.8 | 11.3 | 22.3 | 20.4 | 19.3 | 19.7 | 16.1 | 25 | 21.5 |
| Dissolved Metals | | | | | | | | | | | |
| Aluminum (Al)-Dissolved | mg/L | <0.0050 | <0.0050 | 0.0068 | <0.0050 | <0.0050 | <0.0050 | <0.0050 | <0.0050 | <0.0050 | <0.0050 |
| Antimony (Sb)-Dissolved | mg/L | <0.00010 | <0.00010 | <0.00010 | <0.00010 | <0.00010 | <0.00010 | <0.00010 | <0.00010 | <0.00010 | <0.00010 |
| Arsenic (As)-Dissolved | mg/L | 0.00018 | 0.00017 | 0.00018 | 0.00013 | 0.00019 | 0.00017 | 0.00025 | 0.0002 | 0.00022 | 0.0002 |
| Barium (Ba)-Dissolved | mg/L | 0.0352 | 0.0375 | 0.0475 | 0.0513 | 0.0396 | 0.0428 | 0.0427 | 0.04 | 0.0431 | 0.0414 |
| Beryllium (Be)-Dissolved | mg/L | <0.00010 | <0.00010 | <0.00010 | <0.00010 | <0.00010 | <0.00010 | <0.00010 | <0.00010 | <0.00010 | <0.00010 |
| Bismuth (Bi)-Dissolved | mg/L | <0.000050 | <0.000050 | <0.000050 | <0.000050 | <0.000050 | <0.000050 | <0.000050 | <0.000050 | <0.000050 | <0.000050 |
| Boron (B)-Dissolved | mg/L | <0.010 | <0.010 | <0.010 | 0.012 | 0.014 | 0.014 | 0.015 | 0.013 | 0.014 | 0.011 |
| Cadmium (Cd)-Dissolved | mg/L | 0.0000255 | 0.0000412 | 0.0000253 | 0.0000807 | 0.0000318 | 0.0000325 | 0.0000182 | 0.0000176 | 0.0000206 | 0.0000121 |
| Calcium (Ca)-Dissolved | mg/L | 68.5 | 73.2 | 97.7 | 70.6 | 72.1 | 72.8 | 71.2 | 67.4 | 76.2 | 69.8 |
| Cesium (Cs)-Dissolved | mg/L | <0.000010 | <0.000010 | <0.000010 | <0.000010 | <0.000010 | <0.000010 | <0.000010 | <0.000010 | <0.000010 | <0.000010 |
| Chromium (Cr)-Dissolved | mg/L | <0.00050 | <0.00050 | <0.00050 | <0.00050 | <0.00050 | <0.00050 | <0.00050 | <0.00050 | <0.00050 | <0.00050 |
| Cobalt (Co)-Dissolved | mg/L | <0.00010 | 0.00011 | <0.00010 | <0.00010 | <0.00010 | <0.00010 | <0.00010 | <0.00010 | <0.00010 | <0.00010 |
| Copper (Cu)-Dissolved | mg/L | 0.00053 | 0.0004 | 0.00048 | 0.00076 | 0.00053 | 0.00063 | 0.00063 | 0.00088 | 0.00078 | 0.00055 |
| Iron (Fe)-Dissolved | mg/L | <0.010 | <0.010 | <0.010 | <0.010 | <0.010 | <0.010 | <0.010 | <0.010 | <0.010 | <0.010 |
| Lead (Pb)-Dissolved | mg/L | <0.000050 | <0.000050 | <0.000050 | <0.000050 | <0.000050 | <0.000050 | <0.000050 | <0.000050 | <0.000050 | <0.000050 |
| Lithium (Li)-Dissolved | mg/L | <0.00010 | <0.00010 | 0.0011 | <0.00010 | 0.0015 | 0.0018 | 0.0012 | 0.0018 | 0.002 | 0.0018 |
| Magnesium (Mg)-Dissolved | mg/L | 19.1 | 22.4 | 28.1 | 19.8 | 18.9 | 19.7 | 19.7 | 19.4 | 19.7 | 21.2 |
| Manganese (Mn)-Dissolved | mg/L | 0.009 | 0.0096 | 0.0205 | 0.00094 | 0.00603 | 0.0119 | 0.00589 | 0.00824 | 0.00986 | 0.00736 |
| Molybdenum (Mo)-Dissolved | mg/L | 0.00029 | 0.000224 | 0.000144 | 0.000907 | 0.000213 | 0.000223 | 0.000225 | 0.000218 | 0.000249 | 0.000195 |
| Nickel (Ni)-Dissolved | mg/L | 0.00099 | 0.00534 | 0.0006 | 0.00075 | 0.00228 | 0.00146 | 0.00051 | <0.00050 | <0.00050 | 0.00055 |
| Phosphorus (P)-Dissolved | mg/L | <0.050 | <0.050 | <0.050 | <0.050 | <0.050 | <0.050 | <0.050 | <0.050 | <0.050 | <0.050 |
| Potassium (K)-Dissolved | mg/L | 1.090 | 1.04 | 1.18 | 1.34 | 1.21 | 1.38 | 1.54 | 1.46 | 1.59 | 1.5 |
| Rubidium (Rb)-Dissolved | mg/L | 0.00053 | 0.00051 | 0.00087 | 0.00092 | 0.00073 | 0.00097 | 0.00097 | 0.00097 | 0.00105 | 0.00095 |
| Selenium (Se)-Dissolved | mg/L | 0.00018 | 0.000242 | 0.000151 | 0.000171 | 0.000093 | 0.000183 | 0.000364 | 0.00009 | 0.000335 | 0.000376 |
| Silicon (Si)-Dissolved | mg/L | 3.74 | 3.9 | 4.88 | 5.11 | 5.11 | 5.32 | 5.36 | 5.19 | 5.58 | 5.26 |
| Silver (Ag)-Dissolved | mg/L | <0.000050 | <0.000050 | <0.000050 | <0.000050 | <0.000050 | <0.000050 | <0.000050 | <0.000050 | <0.000050 | <0.000050 |
| Sodium (Na)-Dissolved | mg/L | 13.7 | 14.4 | 18.4 | 13.9 | 12.7 | 13.6 | 14.3 | 13.4 | 13.8 | 13.2 |
| Strontium (Sr)-Dissolved | mg/L | 0.122 | 0.13 | 0.157 | 0.129 | 0.124 | 0.13 | 0.128 | 0.119 | 0.141 | 0.129 |
| Sulfur (S)-Dissolved | mg/L | 6.7 | 6.1 | 4.18 | 7.81 | 7.01 | 7.31 | 7.34 | 5.65 | 8.39 | 7.56 |
| Tellurium (Te)-Dissolved | mg/L | <0.00020 | <0.00020 | <0.00020 | <0.00020 | <0.00020 | <0.00020 | <0.00020 | <0.00020 | <0.00020 | <0.00020 |
| Thallium (Tl)-Dissolved | mg/L | <0.000010 | <0.000010 | <0.000010 | 0.000015 | <0.000010 | <0.000010 | <0.000010 | <0.000010 | 0.000011 | <0.000010 |
| Thorium (Th)-Dissolved | mg/L | <0.00010 | <0.00010 | <0.00010 | <0.00010 | <0.00010 | <0.00010 | <0.00010 | <0.00010 | <0.00010 | <0.00010 |
| Tin (Sn)-Dissolved | mg/L | <0.00010 | <0.00010 | <0.00010 | <0.00010 | <0.00010 | <0.00010 | <0.00010 | <0.00010 | <0.00010 | <0.00010 |
| Titanium (Ti)-Dissolved | mg/L | <0.00030 | <0.00030 | <0.00030 | <0.00030 | <0.00030 | <0.00030 | <0.00030 | <0.00030 | <0.00030 | <0.00030 |
| Tungsten (W)-Dissolved | mg/L | <0.00010 | <0.00010 | <0.00010 | <0.00010 | <0.00010 | <0.00010 | <0.00010 | <0.00010 | <0.00010 | <0.00010 |
| Uranium (U)-Dissolved | mg/L | 0.000588 | 0.000622 | 0.000596 | 0.000424 | 0.000355 | 0.000301 | 0.000401 | 0.000395 | 0.000324 | 0.000371 |
| Vanadium (V)-Dissolved | mg/L | <0.00050 | <0.00050 | <0.00050 | <0.00050 | <0.00050 | <0.00050 | <0.00050 | <0.00050 | <0.00050 | <0.00050 |
| Zinc (Zn)-Dissolved | mg/L | 0.43 | 0.669 | 0.166 | 1.93 | 0.95 | 1.53 | 0.0445 | 0.0363 | 1.08 | 0.103 |
| Zirconium (Zr)-Dissolved | mg/L | <0.00020 | <0.00020 | <0.00020 | <0.00020 | <0.00020 | <0.00020 | <0.00020 | <0.00020 | <0.00020 | <0.00020 |

Table 2: Water Quality Results Summary

| Sample Location: | | DP3 | | | | | | | | | | |
|-----------------------------|-------|-------------|------------|-------------|------------|-------------|-------------|-------------|------------|-------------|------------|-------------|
| | Date: | 24-Apr-2020 | 4-May-2020 | 27-May-2020 | 9-Jun-2020 | 25-Jun-2020 | 10-Jul-2020 | 22-Jul-2020 | 7-Aug-2020 | 25-Aug-2020 | 4-Sep-2020 | 18-Sep-2020 |
| Parameter | Units | Water | Water | Water | Water | Water | Water | Water | Water | Water | Water | Water |
| Anions and Nutrients | | | | | | | | | | | | |
| Bromide (Br) | mg/L | <0.10 | <0.10 | <0.10 | <0.10 | <0.10 | <0.10 | <0.10 | <0.10 | <0.10 | <0.10 | <0.10 |
| Chloride (Cl) | mg/L | 20.9 | 21.4 | 21.7 | 21.1 | 22.6 | 22.8 | 21.1 | 22.1 | 22.0 | 21.2 | 23.8 |
| Fluoride (F) | mg/L | 0.055 | 0.055 | 0.055 | 0.057 | 0.053 | 0.062 | 0.057 | 0.033 | 0.050 | 0.056 | 0.035 |
| Nitrate (as N) | mg/L | 0.060 | <0.020 | <0.020 | 0.020 | <0.020 | <0.020 | <0.020 | <0.020 | <0.020 | <0.020 | <0.020 |
| Nitrite (as N) | mg/L | <0.010 | <0.010 | <0.010 | <0.010 | <0.010 | <0.010 | <0.010 | <0.010 | <0.010 | <0.010 | <0.010 |
| Sulfate (SO4) | mg/L | 32.7 | 32.7 | 28.3 | 20.1 | 16.8 | 11.9 | 8.3 | 159 | 98.1 | 94.5 | 71.7 |
| Dissolved Metals | | | | | | | | | | | | |
| Aluminum (Al)-Dissolved | mg/L | 0.0058 | <0.0050 | <0.0050 | 0.2920 | 0.0056 | <0.0050 | <0.0050 | <0.0050 | <0.0050 | <0.0050 | <0.0050 |
| Antimony (Sb)-Dissolved | mg/L | <0.00010 | 0.00011 | <0.00010 | <0.00010 | <0.00010 | <0.00010 | <0.00010 | <0.00010 | <0.00010 | <0.00010 | <0.00010 |
| Arsenic (As)-Dissolved | mg/L | 0.00088 | 0.00507 | 0.00522 | 0.00564 | 0.00460 | 0.00489 | 0.00425 | 0.00683 | 0.00733 | 0.00501 | 0.00563 |
| Barium (Ba)-Dissolved | mg/L | 0.0750 | 0.0664 | 0.0801 | 0.1030 | 0.0696 | 0.0752 | 0.0714 | 0.1110 | 0.0927 | 0.0812 | 0.0904 |
| Beryllium (Be)-Dissolved | mg/L | <0.00010 | <0.00010 | <0.00010 | <0.00010 | <0.00010 | <0.00010 | <0.00010 | <0.00010 | <0.00010 | <0.00010 | <0.00010 |
| Bismuth (Bi)-Dissolved | mg/L | <0.000050 | <0.000050 | <0.000050 | <0.000050 | <0.000050 | <0.000050 | <0.000050 | <0.000050 | <0.000050 | <0.000050 | <0.000050 |
| Boron (B)-Dissolved | mg/L | <0.010 | <0.010 | <0.010 | <0.010 | 0.011 | 0.011 | 0.01 | 0.013 | 0.012 | 0.011 | 0.012 |
| Cadmium (Cd)-Dissolved | mg/L | <0.0000050 | <0.0000050 | 0.0000129 | 0.0000467 | <0.0000050 | <0.0000050 | <0.0000050 | 0.0000098 | <0.0000050 | <0.0000050 | <0.0000050 |
| Calcium (Ca)-Dissolved | mg/L | 85.5 | 88.3 | 96.7 | 109.0 | 113.0 | 109.0 | 105.0 | 139.0 | 120.0 | 121.0 | 123.0 |
| Cesium (Cs)-Dissolved | mg/L | <0.000010 | <0.000010 | <0.000010 | 0.000014 | <0.000010 | <0.000010 | <0.000010 | <0.000010 | <0.000010 | <0.000010 | <0.000010 |
| Chromium (Cr)-Dissolved | mg/L | <0.00050 | <0.00050 | <0.00050 | 0.00056 | <0.00050 | <0.00050 | <0.00050 | <0.00050 | <0.00050 | <0.00050 | <0.00050 |
| Cobalt (Co)-Dissolved | mg/L | 0.00150 | 0.00043 | 0.00046 | 0.00097 | 0.00035 | 0.00015 | 0.00014 | 0.00079 | 0.00088 | 0.00032 | 0.00052 |
| Copper (Cu)-Dissolved | mg/L | <0.00020 | <0.00020 | <0.00020 | 0.00152 | 0.00039 | <0.00020 | <0.00020 | <0.00020 | 0.00021 | <0.00020 | <0.00020 |
| Iron (Fe)-Dissolved | mg/L | <0.010 | 7.94 | 8.51 | 6.8 | 9.52 | 8.19 | 6.89 | 11.3 | 9.11 | 7.57 | 7.05 |
| Lead (Pb)-Dissolved | mg/L | 0.000135 | <0.000050 | <0.000050 | 0.004380 | <0.000050 | <0.000050 | <0.000050 | <0.000050 | <0.000050 | <0.000050 | <0.000050 |
| Lithium (Li)-Dissolved | mg/L | <0.0010 | <0.0010 | 0.0011 | <0.0010 | <0.0010 | 0.0011 | 0.0012 | <0.0010 | 0.001 | <0.0010 | <0.0010 |
| Magnesium (Mg)-Dissolved | mg/L | 19.0 | 18.0 | 21.1 | 23.4 | 22.6 | 21.9 | 22.5 | 28.5 | 25.1 | 23.1 | 24.9 |
| Manganese (Mn)-Dissolved | mg/L | 0.849 | 0.878 | 1.170 | 1.280 | 1.160 | 1.030 | 0.977 | 1.410 | 1.190 | 1.050 | 1.150 |
| Molybdenum (Mo)-Dissolved | mg/L | 0.00106 | 0.00075 | 0.00080 | 0.00076 | 0.00111 | 0.00079 | 0.00089 | 0.00061 | 0.00095 | 0.00082 | 0.00070 |
| Nickel (Ni)-Dissolved | mg/L | 0.00450 | 0.01330 | 0.00908 | 0.00318 | 0.01190 | 0.00109 | 0.00058 | 0.00842 | 0.01920 | 0.00879 | 0.01140 |
| Phosphorus (P)-Dissolved | mg/L | <0.050 | 0.057 | 0.056 | 0.073 | 0.052 | <0.050 | <0.050 | 0.09 | <0.050 | <0.050 | <0.050 |
| Potassium (K)-Dissolved | mg/L | 0.768 | 0.441 | 0.537 | 0.703 | 0.529 | 0.566 | 0.576 | 0.711 | 0.679 | 0.565 | 0.607 |
| Rubidium (Rb)-Dissolved | mg/L | 0.00097 | 0.00051 | 0.00063 | 0.00104 | 0.00063 | 0.00066 | 0.00065 | 0.00085 | 0.00087 | 0.00069 | 0.00075 |
| Selenium (Se)-Dissolved | mg/L | <0.000050 | 0.000056 | 0.000065 | 0.000511 | <0.000050 | 0.000066 | 0.000066 | 0.00008 | <0.000050 | 0.000051 | 0.000072 |
| Silicon (Si)-Dissolved | mg/L | 5.51 | 6.43 | 7.14 | 8.50 | 8.42 | 8.16 | 8.13 | 8.89 | 8.22 | 8.03 | 8.32 |
| Silver (Ag)-Dissolved | mg/L | <0.000050 | <0.000050 | <0.000050 | <0.000050 | <0.000050 | <0.000050 | <0.000050 | <0.000050 | <0.000050 | <0.000050 | <0.000050 |
| Sodium (Na)-Dissolved | mg/L | 11.6 | 10.0 | 10.5 | 11.5 | 10.4 | 10.7 | 11.1 | 12.2 | 11.5 | 11.3 | 11.4 |
| Strontium (Sr)-Dissolved | mg/L | 0.124 | 0.129 | 0.149 | 0.159 | 0.155 | 0.153 | 0.159 | 0.205 | 0.187 | 0.185 | 0.189 |
| Sulfur (S)-Dissolved | mg/L | 12.2 | 11.0 | 8.9 | 7.6 | 5.4 | 4.3 | 3.6 | 56.7 | 34.9 | 31.2 | 23.7 |
| Tellurium (Te)-Dissolved | mg/L | <0.00020 | <0.00020 | <0.00020 | <0.00020 | <0.00020 | <0.00020 | <0.00020 | <0.00020 | <0.00020 | <0.00020 | <0.00020 |
| Thallium (Tl)-Dissolved | mg/L | <0.000010 | <0.000010 | <0.000010 | 0.000012 | <0.000010 | <0.000010 | <0.000010 | <0.000010 | <0.000010 | <0.000010 | <0.000010 |
| Thorium (Th)-Dissolved | mg/L | <0.00010 | <0.00010 | <0.00010 | <0.00010 | <0.00010 | <0.00010 | <0.00010 | <0.00010 | <0.00010 | <0.00010 | <0.00010 |
| Tin (Sn)-Dissolved | mg/L | <0.00010 | <0.00010 | <0.00010 | <0.00010 | <0.00010 | <0.00010 | <0.00010 | <0.00010 | <0.00010 | <0.00010 | <0.00010 |
| Titanium (Ti)-Dissolved | mg/L | 0.00030 | 0.00034 | 0.00032 | 0.00814 | 0.00035 | <0.00030 | <0.00030 | 0.00030 | 0.00033 | <0.00030 | <0.00030 |
| Tungsten (W)-Dissolved | mg/L | <0.00010 | <0.00010 | <0.00010 | <0.00010 | <0.00010 | <0.00010 | <0.00010 | <0.00010 | <0.00010 | <0.00010 | <0.00010 |
| Uranium (U)-Dissolved | mg/L | 0.000185 | 0.000081 | 0.000156 | 0.000198 | 0.000115 | 0.000091 | 0.000104 | 0.000283 | 0.000413 | 0.000210 | 0.000219 |
| Vanadium (V)-Dissolved | mg/L | <0.00050 | 0.0016 | 0.00163 | 0.00257 | 0.00146 | 0.00119 | 0.00113 | 0.00119 | 0.00109 | 0.00113 | 0.00108 |
| Zinc (Zn)-Dissolved | mg/L | 3.43 | 0.59 | 1.88 | 2.35 | 1.82 | 1.43 | 1.51 | 0.72 | 1.41 | 0.31 | 0.41 |
| Zirconium (Zr)-Dissolved | mg/L | <0.00020 | 0.00032 | 0.00035 | 0.00055 | 0.00045 | 0.00043 | 0.00042 | 0.00049 | 0.00045 | 0.0005 | 0.0004 |

Table 2: Water Quality Results Summary